

**NOTICE!!**

**These documents have been scanned!**

**Do not place un-scanned documents beneath this notice!**

**Do not remove this notice from this file!**

GPO Jacket No. 560-102  
Print Order 61540  
Rise Business Services, LLC  
Job=AZ15 5/13/2019



Box Number= AZ15041



Claim Begin-End: AMC421247-AMC421252

1 Initial Receipt



AZ15041-15

AMC421078-AMC422564

**United States Department of the Interior**  
**Bureau of Land Management**  
 LANDS/RECREATION & PLANNING  
 ONE N CENTRAL AVE  
 PHOENIX, AZ 85004 -2203  
 Phone: 602-417-9200

Receipt

No: 2745324

<b>Transaction #:</b> 2828486		<b>ENTERED INTO COMPUTER</b>
<b>Date of Transaction:</b> 02/25/2013		
<b>CUSTOMER:</b>		
MAR 05 2013 <i>QB</i>		
IVY MINERALS INC PO BOX 2532 BOISE, ID 83701-2532 US		

LINE #	QTY	DESCRIPTION	REMARKS	UNIT PRICE	TOTAL
1	6.00	LOCATABLE MINERALS / MINING CLAIMS-NEW, UNADJUD, ONE OR MORE AUTH NOS / NEW MINING CLAIM LOCATION FEE \$34 <b>CASES:</b> AMC421247/\$34.00, AMC421248/\$34.00, AMC421249/\$34.00, AMC421250/\$34.00, AMC421251/\$34.00, AMC421252/\$34.00		- n/a -	204.00
2	6.00	LOCATABLE MINERALS / MINING CLAIMS-NEW, UNADJUD, ONE OR MORE AUTH NOS / NEW MINING CLAIM PROCESSING FEE \$15 <b>CASES:</b> AMC421247/\$15.00, AMC421248/\$15.00, AMC421249/\$15.00, AMC421250/\$15.00, AMC421251/\$15.00, AMC421252/\$15.00		- n/a -	90.00
3	6.00	LOCATABLE MINERALS / MINING CLAIMS-NEW, UNADJUD, ONE OR MORE AUTH NOS / NEW MINING CLAIM MAINT FEE \$140 <b>CASES:</b> AMC421247/\$140.00, AMC421248/\$140.00, AMC421249/\$140.00, AMC421250/\$140.00, AMC421251/\$140.00, AMC421252/\$140.00		- n/a -	840.00
<b>TOTAL:</b>					<b>\$1,134.00</b>

PAYMENT INFORMATION			
1	AMOUNT:	1134.00	POSTMARKED: N/A
	TYPE:	CHECK	RECEIVED: 02/25/2013
	CHECK NO:	1237	
	NAME:	KAATERSKILL EXPLORATION 1739 TATUM PL PRESCOTT AZ 86301 US	

REMARKS
---------

This receipt was generated by the automated BLM Collections and Billing System and is a paper representation of a portion of the official electronic record contained therein.

**NOTICE!!**

**These documents have been scanned!**

**Do not place un-scanned documents beneath this notice!**

**Do not remove this notice from this file!**

GPO Jacket No. 560-102  
Print Order 61540  
Rise Business Services, LLC  
Job=AZ15 5/13/2019



Box Number= AZ15041



Claim Begin-End: AMC421247-AMC421252

2 Correspondence



AZ15041-15

AMC421078-AMC422564

**NO  
DOCUMENTS  
FOUND**

NO DOCUMENTS FOUND  
NO DOCUMENTS FOUND

**NOTICE!!**

**These documents have been scanned!**

**Do not place un-scanned documents beneath this notice!**

**Do not remove this notice from this file!**

GPO Jacket No. 560-102  
Print Order 61540  
Rise Business Services, LLC  
Job=AZ15 5/13/2019



Box Number= AZ15041



Claim Begin-End: AMC421247-AMC421252

3 Transfers



AZ15041-15

AMC421078-AMC422564

**NO  
DOCUMENTS  
FOUND**

NO DOCUMENTS FOUND  
NO DOCUMENTS FOUND

**NOTICE!!**

**These documents have been scanned!**

**Do not place un-scanned documents beneath this notice!**

**Do not remove this notice from this file!**

GPO Jacket No. 560-102  
Print Order 61540  
Rise Business Services, LLC  
Job=AZ15 5/13/2019



Box Number= AZ15041



Claim Begin-End: AMC421247-AMC421252

4 Miscellaneous



AZ15041-15

AMC421078-AMC422564



**NO  
DOCUMENTS  
FOUND**

NO DOCUMENTS FOUND  
NO DOCUMENTS FOUND

**NOTICE!!**

**These documents have been scanned!**

**Do not place un-scanned documents beneath this notice!**

**Do not remove this notice from this file!**

GPO Jacket No. 560-102  
Print Order 61540  
Rise Business Services, LLC  
Job=AZ15 5/13/2019



Box Number= AZ15041



Claim Begin-End: AMC421247-AMC421252

5 Annual Filings



AZ15041-15

AMC421078-AMC422564

Ivy Minerals Inc.  
P.O. Box 2532  
Boise, Idaho 83701

415427

421247

July 20, 2018

VIA Federal Express

United States Bureau of Land Management  
Suite 800  
One North Central Avenue  
Phoenix, Arizona 85004-4427

RECEIVED  
BLM AZ STATE OFFICE  
2018 JUL 23 P 3:11  
PHOENIX, ARIZONA

Re: Maintenance Fee Payment for Cobre Sud #1 through #16 Claims  
Yavapai County, Arizona

**BLM Serial #'s AMC # 415427 through AMC # 415436 and  
AMC # 421247 through AMC # 421252**

Greetings:

Enclosed is a check in the amount of \$2,480 in payment of the maintenance fees due on or before September 1, 2018 for the above referenced unpatented lode mining claims. I have enclosed a self-addressed stamped envelope for returning the receipt.

Thank you very much for your help in this matter.

Sincerely,

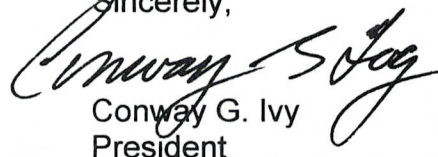
  
Conway G. Ivy  
President

ENTERED  
JUL 31 2018  
BY: RAM

**UNITED STATES BUREAU OF LAND MANAGEMENT**  
**CLAIM MAINTENANCE FEES**  
July 20, 2018

Enclosed are claim maintenance fees in the amount of \$2,480.00 [\$155.00 per claim] for the Claims listed below:

<u>No.</u>	<u>IMC NUMBER</u>	<u>CLAIM NAME</u>
1.	415427 7	Cobre Sud #1
2.	415428	Cobre Sud #2
3.	415429	Cobre Sud #3
4.	415430	Cobre Sud #4
5.	415431	Cobre Sud #5
6.	415432	Cobre Sud #6
7.	415433	Cobre Sud #7
8.	415434	Cobre Sud #8
9.	415435	Cobre Sud #9
10.	415436 J	Cobre Sud #10
11.	421247 7	Cobre Sud #11
12.	421248	Cobre Sud #12
13.	421249	Cobre Sud #13
14.	421250	Cobre Sud #14
15.	421251 J	Cobre Sud #15
16.	421252 J	Cobre Sud #16

RECEIVED  
BLM AZ STATE OFFICE  
2018 JUL 23 P 3:11  
PHOENIX, ARIZONA

Located in T12N, R2E, Section 30 and T12N, R1E, Section 25, and recorded in the records of Yavapai County, Arizona in Book 4875, pages 577 through 586 and Book 4942, pages 688 through 690 all for the benefit of Ivy Minerals Inc.

Submitted by:

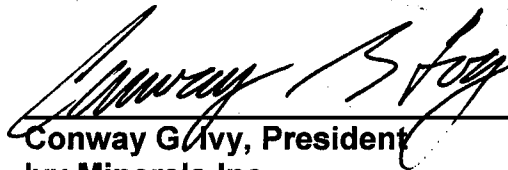

Conway G. Ivy, President  
Ivy Minerals Inc.  
P.O. Box 2532  
Boise, Idaho 83701  
440 - 796 - 7503 [telephone]

# 4218338

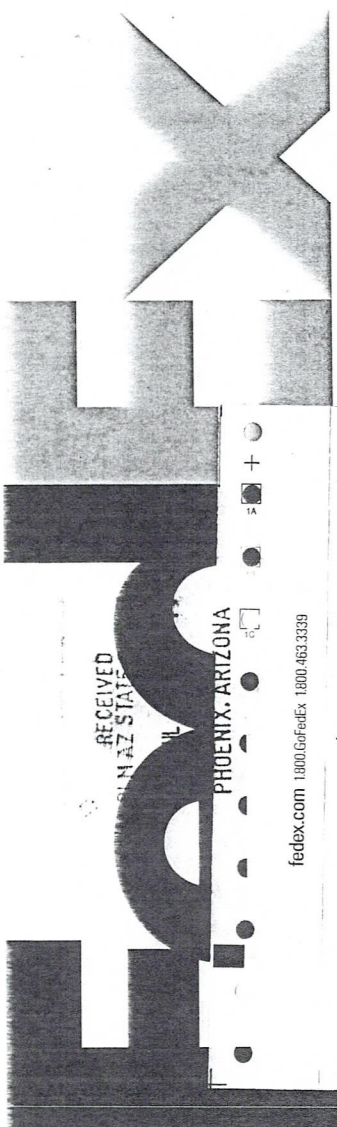

**earth smart**  
 FedEx carbon-neutral  
 envelope shipping

press

RT 277 7 D  
 ST 24.2 16:00 4675  
 07.23

Align top of FedEx Express® shipping label here.

**FedEx**  
 TRK# 8106 8326 4675  
 0200

MON - 23 JUL AA  
 STANDARD OVERNIGHT

XH ZSYA

85004  
 AZ-US  
 PHX



FID 57683 21JUL10 SAVA 546C2/8532/RCBA

**FedEx** Package Express **US Airbill** FedEx Tracking Number **8106 8326 4675**

Form ID No. **0200**

Recipient's Copy

1 From **Conway G. Ivy** Date **7/21/10**

Sender's Name **Conway G. Ivy** Phone **410 996-7503**

Company **Ivy Minerals Inc**

Address **501 King Street**

City **Beaufort** State **SC** ZIP **29902**

2 Your Internal Billing Reference

3 To Recipient's Name **U.S. Bureau of Land Management** Phone

Company **U.S. Bureau of Land Management**

Address **Suite 300** Hold Weekend  
 We cannot deliver to P.O. boxes or P.O. ZIP codes. FedEx location address required. NOT available for FedEx First Overnight.

Address **One North Central Avenue** Hold Saturday  
 FedEx location address required. Available ONLY for FedEx Priority Overnight and FedEx 2Day to select locations.

City **PHOENIX** State **AZ** ZIP **85004**

4 Express Package Service \*To meet locations. Packages up to 150 lbs. For packages over 150 lbs, see the FedEx Express Freight US Airbill.

Next Business Day  
 FedEx First Overnight  
 FedEx Priority Overnight  
 FedEx Standard Overnight  
 FedEx 2Day A.M.  
 FedEx 2Day  
 FedEx Express Saver

5 Packaging \*Declared value limit \$500.  
 FedEx Envelope\*  FedEx Pak\*  FedEx Box  FedEx Tube  Other

6 Special Handling and Delivery Signature Options Fees may apply. See the FedEx Service Guide.  
 Saturday Delivery  
 No Signature Required  
 Direct Signature  
 Indirect Signature

Does this shipment contain dangerous goods?  
 No  Yes  Shipper's Declaration  Dry Ice  Cargo Aircraft Only

7 Payment Bill to: Enter FedEx Acct. No. or Credit Card No. below.  
 Sender  Recipient  Third Party  Credit Card  Cash/Check

Total Packages Total Weight Credit Card Auth.



8106 8326 4675

\*Our liability is limited to USD\$100 unless you declare a higher value. See the current FedEx Service Guide for details.  
 Rev. 05/10 Form #107001 ©2010-2011 FedEx • PRINTED IN U.S.A. RMA 0000

644

PHOENIX, ARIZONA  
 fedex.com 1.800.GoFedEx 1.800.463.3339

fedex.com 1.800.GoFedEx 1.800.463.3339

earthsmart

FedEx carbon-neutral envelope shipping

RT 277 7 15:00 D  
ST 24.2 4675 07.23

FedEx  
TRK# 8106 8326 4675  
0200

MON - 23 JUL AA  
STANDARD OVERNIGHT

XH ZSYA

85004  
AZ-US  
PHX



FID 57603 21JUL18 SAVA 546CZ/8532/0C8A

FedEx Express

Package US Airbill

FedEx Tracking Number 8106 8326 4675

0200

Recipient's Copy

1 From  
Date 7/21/18  
Sender's Name Conway G. Ivy Phone 440 796-7503  
Company Ivy Minerals Inc  
Address 501 King Street  
City Beaufort SC ZIP 29902

2 Your Internal Billing Reference

3 To  
Recipient's Name U.S. Bureau of Land Management  
Company  
Address Suite 800  
Address One North Central Avenue  
City PHOENIX AZ ZIP 85004

Hold Weekday  
FedEx location address REQUIRED, NOT available for FedEx First Overnight.

Hold Saturday  
FedEx location address REQUIRED, Available ONLY for FedEx Priority Overnight and FedEx 2Day to select locations.

4 Express Package Service

Next Business Day  
 FedEx First Overnight  
 FedEx Priority Overnight  
 FedEx Standard Overnight

2 or 3 Business Days  
 FedEx 2Day A.M.  
 FedEx 2Day  
 FedEx Express Saver

5 Packaging  
 FedEx Envelope\*  
 FedEx Pak\*  
 FedEx Box  
 FedEx Tube  
 Other

6 Special Handling and Delivery Signature Options  
 Saturday Delivery  
 No Signature Required  
 Direct Signature  
 Indirect Signature

Does this shipment contain dangerous goods?  
 No  
 Yes  
 Yes  
 Dry Ice  
 Cargo Aircraft Only

7 Payment Bill to:  
 Sender  
 Recipient  
 Third Party  
 Credit Card  
 Cash/Check

Total Packages Total Weight Credit Card Auth.



8106 8326 4675

Our liability is limited to US\$100 unless you declare a higher value. See the current FedEx Service Guide for details.  
Rev. Date 2/15 • Part #167002 • ©2012-2015 FedEx • PRINTED IN U.S.A. ARDA 00/00

644

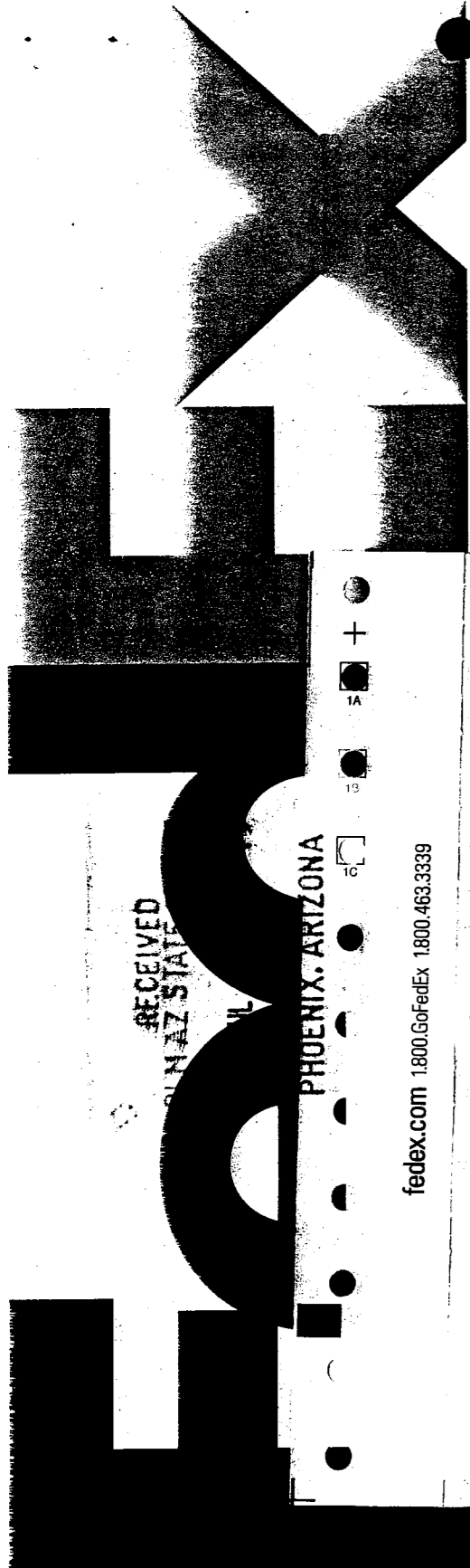

fedex.com 1.800.GoFedEx 1.800.463.3339

fedex.com 1.800.GoFedEx 1.800.463.3339

**United States Department of the Interior**  
**Bureau of Land Management**  
 DIV OF LANDS, MINRLS & ENERGY  
 ONE N CENTRAL AVE  
 PHOENIX, AZ 85004 -4427  
 Phone: 602-417-9200

Receipt

No: 4218338

<b>Transaction #:</b> 4333501	
<b>Date of Transaction:</b> 07/24/2018	
<b>CUSTOMER:</b>	
	IVY MINERALS INC PO BOX 2532 BOISE, ID 83701-2532 US

LINE #	QTY	DESCRIPTION	REMARKS	UNIT PRICE	TOTAL
1	1.00	LOCATABLE MINERALS / MINING CLAIMS- NOT NEW-UNADJUD, ONE AUTH NO. ONLY / MINING CLAIM MONEY RECEIVED <b>CASES: AMC415427/\$2480.00</b>	MAINT 2019/16	- n/a -	2480.00
<b>TOTAL:</b>					<b>\$2,480.00</b>

PAYMENT INFORMATION			
1	AMOUNT:	2480.00	POSTMARKED: N/A
	TYPE:	CHECK	RECEIVED: 07/23/2018
	CHECK NO:	3624	
	NAME:	IVY MINERALS INC PO BOX 1408 BEAUFORT SC 29901 US	

<b>REMARKS</b>

This receipt was generated by the automated BLM Collections and Billing System and is a paper representation of a portion of the official electronic record contained therein.

415427  
421247

**Ivy Minerals Inc  
P. O. Box 2532  
Boise, Idaho 83701.**

June 16, 2017

VIA Federal Express

United States Bureau of Land Management  
Suite 800  
One North Central Avenue  
Phoenix, Arizona 85004-4427

Re: Maintenance Fee Payment for Cobre Sud #1 through #16 Claims  
Yavapai County, Arizona

**BLM Serial #'s AMC # 415427 through AMC # 415436 and  
AMC # 421247 through AMC # 421252**

Greetings:

Enclosed is a check in the amount of \$2,480 in payment of the maintenance fees due on or before September 1, 2017 for the above referenced unpatented lode mining claims. I have enclosed a self-addressed stamped envelope for returning the receipt.

Thank you very much for your help in this matter.

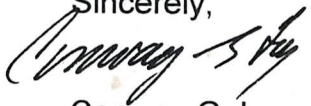
Sincerely,  
  
Conway G. Ivy  
President

RECEIVED  
BLM AZ STATE OFFICE  
2017 JUN 20 P 2:36  
PHOENIX, ARIZONA

ENTERED  
JUN 22 2017  
BY: 

# 3867560



UNITED STATES BUREAU OF LAND MANAGEMENT  
CLAIM MAINTENANCE FEES

June 22, 2017  
16

Enclosed are claim maintenance fees in the amount of \$2,480.00 [\$155.00 per claim] for the Claims listed below:

<u>No.</u>	<u>IMC NUMBER</u>	<u>CLAIM NAME</u>
1.	415427	Cobre Sud #1
2.	415428	Cobre Sud #2
3.	415429	Cobre Sud #3
4.	415430	Cobre Sud #4
5.	415431	Cobre Sud #5
6.	415432	Cobre Sud #6
7.	415433	Cobre Sud #7
8.	415434	Cobre Sud #8
9.	415435	Cobre Sud #9
10.	415436	Cobre Sud #10
11.	421247	Cobre Sud #11
12.	421248	Cobre Sud #12
13.	421249	Cobre Sud #13
14.	421250	Cobre Sud #14
15.	421251	Cobre Sud #15
16.	421252	Cobre Sud #16

Located in T12N, R2E, Section 30 and T12N, R1E, Section 25, and recorded in the records of Yavapai County, Arizona in Book 4875, pages 577 through 586 and Book 4942, pages 688 through 690 all for the benefit of Ivy Minerals Inc.

Submitted by:

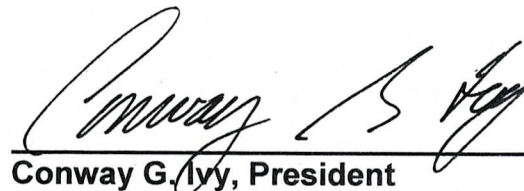

Conway G. Ivy, President  
Ivy Minerals Inc.  
P.O. Box 2532  
Boise, Idaho 83701  
440 - 796 - 7503 [telephone]

PHOENIX, ARIZONA

2017 JUN 20 P 2:36

RECEIVED  
BLM ARIZONA STATE OFFICE

TUE - 20 JUN AA  
STANDARD OVERNIGHT  
85004  
AZ-US  
PHX

FedEx  
TRK# 8105 8824 2420  
0200

XH ZSYA



Form ID No. 0200

4 Express Package Serv

Next Business Day  
FedEx First Overnight  
FedEx Priority Overnight  
FedEx Standard Overnight

5 Packaging  
FedEx Envelope  
FedEx Pak  
FedEx Tube  
Other

6 Special Handling and Delivery  
Saturday Delivery  
No Signature Required

Does this shipment contain dangerous goods?

Payment Bill to:  
Sender  
Recipient  
Third Party

Total Packages  
Total Weight

644

SSS

FedEx Express  
Package US Airbill

1 From  
Date 6-19-2010  
Sender's Name Conway & Ivy  
Company Ivy Innovations Inc  
Address 501 King Street  
City Charleston SC 29902  
State SC ZIP 29902

2 Your Internal Billing Reference

3 To  
Recipients Name U.S. Bureau of Land Management  
Company Cui To 800  
Address 400 North Central Avenue  
City Phoenix AZ 85004-4421  
State AZ ZIP 85004-4421

Hold Weekday  
Hold Saturday  
Hold Sunday

1800.GoFedEx 1800.463.3339

fedex.com 1800.GoFedEx 1800.463.3339

8105 8824 2420

8105 8824 2420

8105 8824 2420

8105 8824 2420

8105 8824 2420

8105 8824 2420

8105 8824 2420

8105 8824 2420

Insert shipping document here

ST 1.2  
278  
15:00  
D

644



8105 8824 2420

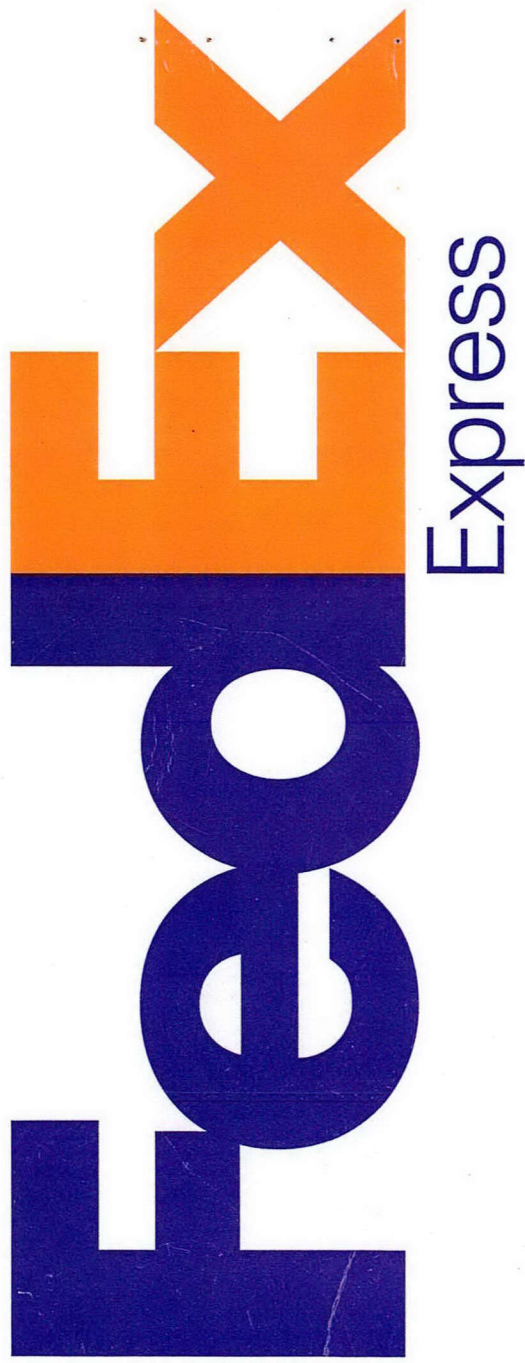

**earthsmart**  
FedEx carbon-neutral  
envelope shipping

Align top of FedEx Express® shipping label here.

# Envelope

RECEIVED  
BLM AZ STATE OFFICE  
2017 JUN 20 P 2:37  
PHOENIX, ARIZONA

**United States Department of the Interior**  
**Bureau of Land Management**  
 DIV OF LANDS, MINRLS & ENERGY  
 ONE N CENTRAL AVE  
 PHOENIX, AZ 85004 -4427  
 Phone: 602-417-9200

Receipt

No: 3867560

<b>Transaction #:</b> 3976521	
<b>Date of Transaction:</b> 06/21/2017	
CUSTOMER:	
IVY MINERALS INC PO BOX 2532 BOISE, ID 83701-2532 US	

LINE #	QTY	DESCRIPTION	REMARKS	UNIT PRICE	TOTAL
1	1.00	LOCATABLE MINERALS / MINING CLAIMS- NOT NEW-UNADJUD, ONE AUTH NO. ONLY / MINING CLAIM MONEY RECEIVED CASES: AMC415427/\$2480.00	MAINT 2018/16	- n/a -	2480.00
<b>TOTAL:</b>					<b>\$2,480.00</b>

PAYMENT INFORMATION					
1	AMOUNT:	2480.00	POSTMARKED:	06/19/2017	
	TYPE:	CHECK	RECEIVED:	06/20/2017	
	CHECK NO:	3389			
	NAME:	IVY MINERALS INC PO BOX 2532 BOISE ID 83701-2532 US			

REMARKS

This receipt was generated by the automated BLM Collections and Billing System and is a paper representation of a portion of the official electronic record contained therein.

Ivy Minerals Inc.  
P.O. Box 2532  
Boise, Idaho 83701  
July 16, 2016

415427

421247

RECEIVED  
BLM AZ STATE OFFICE  
2016 JUL 19 P 3:09  
PHOENIX, ARIZONA

VIA Federal Express

United States Bureau of Land Management  
Suite 800  
One North Central Avenue  
Phoenix, Arizona 85004-4427

Re: Maintenance Fee Payment for Cobre Sud #1 through #16 Claims  
Yavapai County, Arizona

**BLM Serial #'s AMC # 415427 through AMC # 415436 and  
AMC # 421247 through AMC # 421252**

Greetings:

Enclosed is a check in the amount of \$2,480 in payment of the maintenance fees due on or before September 1, 2016 for the above referenced unpatented lode mining claims. I have enclosed a self-addressed stamped envelope for returning the receipt.

Thank you very much for your help in this matter.

Sincerely,

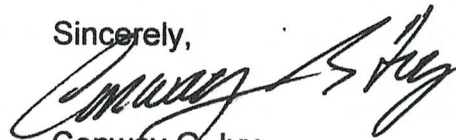

Conway G. Ivy  
President

3610098

# RECEIPT

ENTERED  
JUL 21 2016  
BY: RAm

**UNITED STATES BUREAU OF LAND MANAGEMENT  
CLAIM MAINTENANCE FEES**

July 16, 2016

Enclosed are claim maintenance fees in the amount of \$2,480.00 [\$155.00 per claim] for the Claims listed below:

<u>No.</u>	<u>IMC NUMBER</u>	<u>CLAIM NAME</u>
1.	415427	Cobre Sud #1
2.	415428	Cobre Sud #2
3.	415429	Cobre Sud #3
4.	415430	Cobre Sud #4
5.	415431	Cobre Sud #5
6.	415432	Cobre Sud #6
7.	415433	Cobre Sud #7
8.	415434	Cobre Sud #8
9.	415435	Cobre Sud #9
10.	415436	Cobre Sud #10
11.	421247	Cobre Sud #11
12.	421248	Cobre Sud #12
13.	421249	Cobre Sud #13
14.	421250	Cobre Sud #14
15.	421251	Cobre Sud #15
16.	421252	Cobre Sud #16

Located in T12N, R2E, Section 30 and T12N, R1E, Section 25, and recorded in the records of Yavapai County, Arizona in Book 4875, pages 577 through 586 and Book 4942, pages 688 through 690 all for the benefit of Ivy Minerals Inc.

Submitted by:

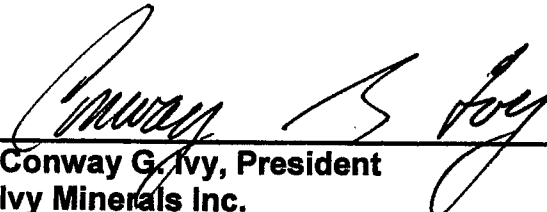

Conway G. Ivy, President  
Ivy Minerals Inc.  
P.O. Box 2532  
Boise, Idaho 83701  
440 - 796 - 7503 [telephone]

PHOENIX, ARIZONA

2016 JUL 19 P 3:09

RECEIVED  
BLM AZ STATE OFFICE

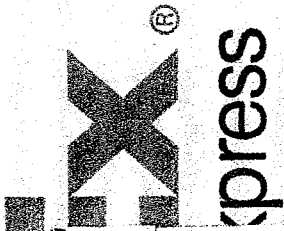

RT 278 ST 1.2 10:30 4512 01:18

FedEx TRK# 8055 8735 4512 0200

TUE - 19 JUL 10:30A PRIORITY OVERNIGHT

85004 AZ-US PHX

XH ZSYA



FID 941597 18JUL16 SAVA 639C1/6C8D/88D2

Extrier

FedEx Express NEW Package US Airbill 8055 8735 4512

0200

1 From Date 7/10/16 Sender's Name Conway & Ivy Company IUV MINORACS INC Address 501 King Street City Beaufort State SC ZIP 29902

2 Your Internal Billing Reference 3 To Recipient's Name U.S. BUREAU OF LAND MANAGEMENT

Address SUITE 800 City PHOENIX State AZ ZIP 85004-4429

4 Express Package Service FedEx First Overnight, FedEx Priority Overnight, FedEx Standard Overnight, FedEx 2Day A.M., FedEx 2Day, FedEx Express Saver

5 Packaging FedEx Envelope, FedEx Pak, FedEx Box, FedEx Tube, Other

6 Special Handling and Delivery Signature Options SATURDAY Delivery, No Signature Required, Direct Signature, Indirect Signature, Dangerous Goods, Dry Ice, Cargo Aircraft Only

7 Payment Bill to Sender, Recipient, Third Party, Credit Card, Cash/Check

fedex.com 1800.GoFedEx 1800.463.3339

fedex.com 1800.GoFedEx 1800.463.3339

Insert shipping document here.



8055 8735 4512

Your liability is limited to US\$200 unless you declare a higher value. See the current FedEx Service Guide for details.

644

Rev. Date 1/12 • Part #1702 • ©2012 FedEx • PRINTED IN U.S.A. 59F

**FedEx**  
Express

**earthsmart**  
FedEx carbon-neutral  
envelope shipping

Align top of FedEx Express® shipping label here.

Envelope

RECEIVED  
BLM AZ SMALL OFFICE  
PHOENIX, ARIZONA  
2016 JUL 19 P 2:36



**United States Department of the Interior**  
**Bureau of Land Management**  
 DIV OF LANDS, MINRLS & ENERGY  
 ONE N CENTRAL AVE  
 PHOENIX, AZ 85004 -4427  
 Phone: 602-417-9200

Receipt

No: 3610098

<b>Transaction #:</b> 3713607	
<b>Date of Transaction:</b> 07/20/2016	
CUSTOMER:	
IVY MINERALS INC PO BOX 2532 BOISE, ID 83701-2532 US	

LINE #	QTY	DESCRIPTION	REMARKS	UNIT PRICE	TOTAL
1	1.00	LOCATABLE MINERALS / MINING CLAIMS- NOT NEW-UNADJUD, ONE AUTH NO. ONLY / MINING CLAIM MONEY RECEIVED CASES: AMC415427/\$2480.00	MAINT FEE 2017 - 16	- n/a -	2480.00
<b>TOTAL:</b>					<b>\$2,480.00</b>

PAYMENT INFORMATION					
1	AMOUNT:	2480.00	POSTMARKED:	07/18/2016	
	TYPE:	CHECK	RECEIVED:	07/19/2016	
	CHECK NO:	3162			
	NAME:	IVY MINERALS INC PO BOX 2532 BOISE ID 83701-2532 US			

REMARKS

This receipt was generated by the automated BLM Collections and Billing System and is a paper representation of a portion of the official electronic record contained therein.

415 427  
421247

Ivy Minerals Inc.  
P.O. Box 2532  
Boise, Idaho 83701  
June 17, 2015

VIA Federal Express

United States Bureau of Land Management  
Suite 800  
One North Central Avenue  
Phoenix, Arizona 85004-4427

Re: Maintenance Fee Payment for Cobre Sud #1 through #16 Claims  
Yavapai County, Arizona

**BLM Serial #'s AMC # 415427 through AMC # 415436 and  
AMC # 421247 through AMC # 421252**

Greetings:

Enclosed is a check in the amount of \$2,480 in payment of the maintenance fees due on or before September 1, 2015 for the above referenced unpatented lode mining claims. I have enclosed a self-addressed stamped envelope for returning the receipt.

Thank you very much for your help in this matter.

Sincerely,

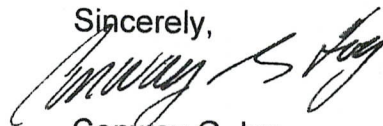

Conway G. Ivy  
President

ENTERED  
JUN 24 2015  
BY: 

RECEIPT # 3326257

RECEIVED  
BLM AZ STATE OFFICE  
2015 JUN 19 A 9:42  
PHOENIX, ARIZONA

**UNITED STATES BUREAU OF LAND MANAGEMENT  
CLAIM MAINTENANCE FEES**

**June 17, 2015**

Enclosed are claim maintenance fees in the amount of \$2,480.00 [\$155.00 per claim] for the Claims listed below:

<u>No.</u>	<u>IMC NUMBER</u>	<u>CLAIM NAME</u>
1.	415427	Cobre Sud #1
2.	415428	Cobre Sud #2
3.	415429	Cobre Sud #3
4.	415430	Cobre Sud #4
5.	415431	Cobre Sud #5
6.	415432	Cobre Sud #6
7.	415433	Cobre Sud #7
8.	415434	Cobre Sud #8
9.	415435	Cobre Sud #9
10.	415436	Cobre Sud #10
11.	421247	Cobre Sud #11
12.	421248	Cobre Sud #12
13.	421249	Cobre Sud #13
14.	421250	Cobre Sud #14
15.	421251	Cobre Sud #15
16.	421252	Cobre Sud #16

Located in T12N, R2E, Section 30 and T12N, R1E, Section 25, and recorded in the records of Yavapai County, Arizona in Book 4875, pages 577 through 586 and Book 4942, pages 688 through 690 all

for the benefit of Ivy Minerals Inc.

Submitted by:

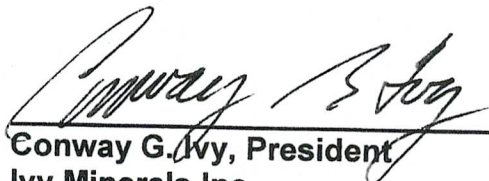
  
Conway G. Ivy, President  
Ivy Minerals Inc.  
P.O. Box 2532  
Boise, Idaho 83701  
440 - 796 - 7503 [telephone]

PHOENIX, ARIZONA

2015 JUN 19 A 9:42

RECEIVED  
BLM AZ STATE OFFICE

**United States Department of the Interior**  
**Bureau of Land Management**  
 LANDS/RECREATION & PLANNING  
 ONE N CENTRAL AVE  
 PHOENIX, AZ 85004 -2203  
 Phone: 602-417-9200

Receipt

No: 3326257

<b>Transaction #:</b> 3423606	
<b>Date of Transaction:</b> 06/22/2015	
<b>CUSTOMER:</b>	
IVY MINERALS INC PO BOX 2532 BOISE, ID 83701-2532 US	

LINE #	QTY	DESCRIPTION	REMARKS	UNIT PRICE	TOTAL
1	1.00	LOCATABLE MINERALS / MINING CLAIMS-NOT NEW-UNADJUD, ONE AUTH NO. ONLY / MINING CLAIM MONEY RECEIVED CASES: AMC415427/\$2480.00	MAINT FEE PYMNT (16) 2016	- n/a -	2480.00
<b>TOTAL:</b>					<b>\$2,480.00</b>

PAYMENT INFORMATION			
1	AMOUNT:	2480.00	POSTMARKED: N/A
	TYPE:	CHECK	RECEIVED: 06/19/2015
	CHECK NO:	2909	
	NAME:	IVY MINERALS INC PO BOX 2532 BOISE ID 83701-2532 US	

REMARKS

This receipt was generated by the automated BLM Collections and Billing System and is a paper representation of a portion of the official electronic record contained therein.

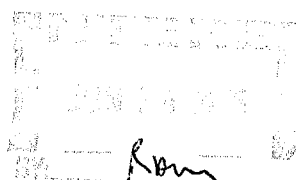
  
 RECEIVED  
 JUN 24 2015  
 R. Brown

6/22/2015

FedEx NEW Package Express US Airbill

FedEx Tracking Number 8061 6467 1003

0200

Recipient's Copy

1 From Date 5/18/2015

Sender's Name Conway B Inv Phone 440 796 7503

Company Inv Minerals Inc

Address P.O. Box 1408

City Beaufort State SC ZIP 29901

2 Your Internal Billing Reference

3 To Recipient's Name

Company UNITED STATES BUREAU OF LAND MANAGEMENT

Address SUITE 800

Address ONE NORTH CENTRAL AVENUE

City PHOENIX State AZ ZIP 85004-4427

4 Express Package Service

Next Business Day or 2 of 3 Business Days. FedEx First Overnight, FedEx Priority Overnight, FedEx Standard Overnight, FedEx 2Day A.M., FedEx 2Day, FedEx Express Saver.

5 Packaging

6 Special Handling and Delivery Signature Options

SATURDAY Delivery, No Signature Required, Direct Signature, Indirect Signature, Dangerous goods, Dry Ice, Cargo Aircraft Only.

7 Payment

Sender, Recipient, Third Party, Credit Card, Cash/Check.



8061 6467 1003

fedex.com 1800.GoFedEx 1800.463.3339

RECEIVED BLM/AST/EE/CFE 2015 JUN 19 10:12 AM ARIZONA

FedEx TRK# 8061 6467 1003

FRI - 19 JUN AA STANDARD OVERNIGHT

XH ZSYA

85004 AZ-US PHX



FD 160563 18JUN16 SAVA 522C1/BA0E/EE48

Handwritten note: R1 275, ST 6.2, 15:00, 4, D, 06.19 1003

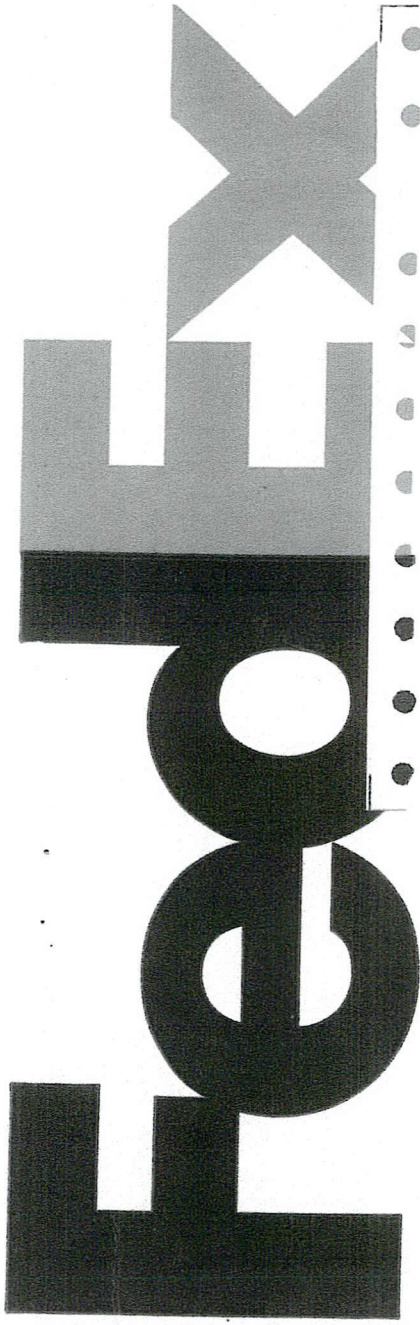

Ivy Minerals Inc.  
P. O. Box 2532  
Boise, Idaho 83701

July 21, 2014

782

Amc 421253  
347088  
~~XXXXXXXXXX~~  
~~XXXXXXXXXX~~  
98  
415427  
421247

VIA PRIORITY MAIL

United States Bureau of Land Management  
Suite 800  
One North Central Avenue  
Phoenix, Arizona 85004-4427

Re: Maintenance Fee Payment for Treasure King Extension #1 through #11  
and Treasure King Extension Fraction Claims, Yavapai County, Arizona

**BLM Serial #'s AMC # 421253 through AMC # 421264**

Greetings:

Enclosed is a check in the amount of \$1860 in payment of the 2015  
maintenance fees for the above referenced unpatented lode mining claims. I  
have enclosed a self-addressed stamped envelope for returning the receipt.  
Thank you very much for your help in this matter.

Sincerely,

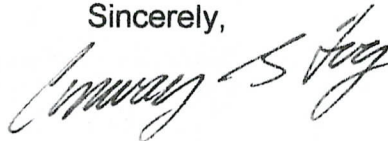

NO. OF CLAIMS 12  
AMOUNT \$1860.00  
RECEIPT NO. 3084950  
INIT. CAH

\*\* BLM-ASO\*\*

RECEIVED  
BLM PHOENIX OFFICE  
2014 JUL 24 P 4:07  
PHOENIX, ARIZONA

ENTERED  
JUL 28 2014  
BY: 

**UNITED STATES BUREAU OF LAND MANAGEMENT  
CLAIM MAINTENANCE FEES**

**July 21, 2014**

Enclosed are claim maintenance fees in the amount of \$1,860.00 [\$155.00 per claim] for the Claims listed below:

<u>No.</u>	<u>IMC NUMBER</u>	<u>CLAIM NAME</u>
1.	421253	Treasure King Extension #1
2.	421254	Treasure King Extension #2
3.	421255	Treasure King Extension #3
4.	421256	Treasure King Extension #4
5.	421257	Treasure King Extension #5
6.	421258	Treasure King Extension #6
7.	421259	Treasure King FRACTION
8.	421260	Treasure King Extension #7
9.	421261	Treasure King Extension #8
10.	421262	Treasure King Extension #9
11.	421263	Treasure King Extension #10
12.	421264	Treasure King Extension #11

Located in T12N, R1E, Section 36, T11.5N, R1E, Section 24 and recorded in the records of Yavapai County, Arizona in Book 4948, pages 991 through 999 and Book 4949, pages 1 through 3 for the benefit of Ivy Minerals Inc. and Searchlight Exploration, LLC

Submitted by:

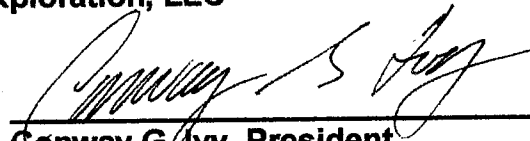

Conway G. Ivy, President  
Ivy Minerals Inc.  
P.O. Box 2532  
Boise, Idaho 83701  
440 - 796 - 7503 [telephone]

PHOENIX, ARIZONA

2014 JUL 24 P 4: 01

RECEIVED  
PHOENIX, ARIZONA

United States Department of the Interior  
 Bureau of Land Management  
 LANDS/RECREATION & PLANNING  
 ONE N CENTRAL AVE  
 PHOENIX, AZ 85004 -2203  
 Phone: 602-417-9200

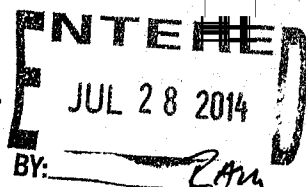

Receipt

BY:

No:

3084950

<b>Transaction #:</b> 3176274	
<b>Date of Transaction:</b> 07/25/2014	
<b>CUSTOMER:</b>	
IVY MINERALS INC PO BOX 2532 BOISE, ID 83701-2532 US	

LINE #	QTY	DESCRIPTION	REMARKS	UNIT PRICE	TOTAL
1	1.00	LOCATABLE MINERALS / MINING CLAIMS-NOT NEW-UNADJUD, ONE AUTH NO. ONLY / MINING CLAIM MONEY RECEIVED CASES: AMC421253/\$1860.00	MAINT FEE PYMNT (12) 2015	- n/a -	1860.00
<b>TOTAL:</b>					<b>\$1,860.00</b>

PAYMENT INFORMATION			
1	AMOUNT:	1860.00	POSTMARKED: 07/22/2014
	TYPE:	CHECK	RECEIVED: 07/24/2014
	CHECK NO:	2719	
	NAME:	IVY MINERALS INC PO BOX 2532 BOISE ID 83701-2532 US	

REMARKS

This receipt was generated by the automated BLM Collections and Billing System and is a paper representation of a portion of the official electronic record contained therein.



Ivy Minerals Inc.  
P. O. Box 2532  
Boise, Idaho 83701

July 21, 2014

VIA PRIORITY MAIL

United States Bureau of Land Management  
Suite 800  
One North Central Avenue  
Phoenix, Arizona 85004-4427

Re: Maintenance Fee Payment for Cordes Peak #1 through #14 Claims  
Yavapai County, Arizona  
BLM Serial #'s AMC # 347088 through AMC # 347101

Greetings:

Enclosed is a check in the amount of \$ 2,170 in payment of the 2015 maintenance fees for the above referenced unpatented lode mining claims. I have enclosed a self-addressed stamped envelope for returning the receipt. Thank you very much for your help in this matter.

Sincerely,

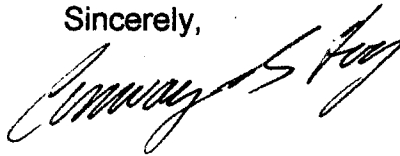

NO. OF CLAIMS 14  
AMOUNT \$2170.00  
RECEIPT NO. 3084953  
INIT. C.A.C.H.

\*\* BLM-ASO\*\*

ENTERED  
JUL 28 2014  
BY: 

PHOENIX, ARIZONA  
2014 JUL 24 P 4:07  
RECEIVED  
BLM SERVICE

**UNITED STATES BUREAU OF LAND MANAGEMENT  
CLAIM MAINTENANCE FEES  
July 21, 2014**

Enclosed are claim maintenance fees in the amount of \$2,170.00 [\$155.00 per claim] for the Claims listed below:

<u>No.</u>	<u>IMC NUMBER</u>	<u>CLAIM NAME</u>
1.	347088	Cordes Peak #1
2.	347089	Cordes Peak #2
3.	347090	Cordes Peak #3
4.	347091	Cordes Peak #4
5.	347092	Cordes Peak #5
6.	347093	Cordes Peak #6
7.	347094	Cordes Peak #7
8.	347095	Cordes Peak #8
9.	347096	Cordes Peak #9
10.	347097	Cordes Peak #10
11.	347098	Cordes Peak #11
12.	347099	Cordes Peak #12
13.	347100	Cordes Peak #13
14.	347101	Cordes Peak #14

All located in T11N, R2E, Section 22 and recorded in the records of Yavapai County, Arizona in Book 3413, pages 666 through 679 for the benefit of Ivy Minerals Inc.

Submitted by:

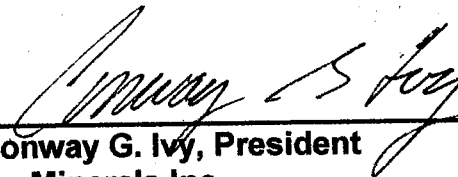
  
\_\_\_\_\_  
Conway G. Ivy, President  
Ivy Minerals Inc.  
P.O. Box 2532  
Boise, Idaho 83701  
440 - 796 - 7503 [telephone]

RECEIVED  
2014 JUL 24 P 4:07  
PHOENIX, ARIZONA

United States Department of the Interior  
 Bureau of Land Management  
 LANDS/RECREATION & PLANNING  
 ONE N CENTRAL AVE  
 PHOENIX, AZ 85004 -2203  
 Phone: 602-417-9200

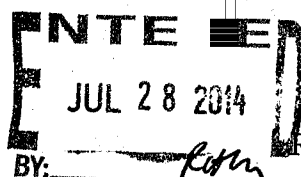

No: 3084953

<b>Transaction #:</b> 3176276	
<b>Date of Transaction:</b> 07/25/2014	
<b>CUSTOMER:</b>	
IVY MINERALS INC PO BOX 2532 BOISE, ID 83701-2532 US	

LINE #	QTY	DESCRIPTION	REMARKS	UNIT PRICE	TOTAL
1	1.00	LOCATABLE MINERALS / MINING CLAIMS-NOT NEW-UNADJUD, ONE AUTH NO. ONLY / MINING CLAIM MONEY RECEIVED CASES: AMC347088/\$2170.00	MAINT FEE PYMNT (14) 2015	- n/a -	2170.00
<b>TOTAL:</b>					<b>\$2,170.00</b>

PAYMENT INFORMATION					
1	AMOUNT:	2170.00	POSTMARKED:	07/22/2014	
	TYPE:	CHECK	RECEIVED:	07/24/2014	
	CHECK NO:	2717			
	NAME:	IVY MINERALS INC PO BOX 2532 BOISE ID 83701-2532 US			

REMARKS

This receipt was generated by the automated BLM Collections and Billing System and is a paper representation of a portion of the official electronic record contained therein.

**Ivy Minerals Inc.  
P. O. Box 2532  
Boise, Idaho 83701**

July 21, 2014

VIA PRIORITY MAIL

United States Bureau of Land Management  
Suite 800  
One North Central Avenue  
Phoenix, Arizona 85004-4427

Re: Maintenance Fee Payment for Cobre Sud #1 through #16 Claims  
Yavapai County, Arizona

**BLM Serial #'s AMC # 415427 through AMC # 415436 and  
AMC # 421247 through AMC # 421252**

Greetings:

Enclosed is a check in the amount of \$2,480 in payment of the 2015 maintenance fees for the above referenced unpatented lode mining claims. I have enclosed a self-addressed stamped envelope for returning the receipt. Thank you very much for your help in this matter.

Sincerely,

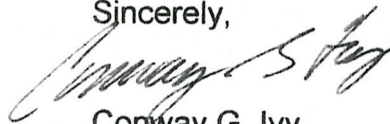

Conway G. Ivy  
President

ENTERED  
JUL 28 2014  
BY: *R. H. M.*

NO. OF CLAIMS 16  
AMOUNT \$2480.00  
RECEIPT NO. 3084957  
INIT. CAH

\*\* BLM-ASO\*\*

PHOENIX, ARIZONA

2014 JUL 24 P 4:01

RECEIVED  
BLM SERVICE

**UNITED STATES BUREAU OF LAND MANAGEMENT  
CLAIM MAINTENANCE FEES**

**July 21, 2014**

Enclosed are claim maintenance fees in the amount of \$2,480.00 [\$155.00 per claim] for the Claims listed below:

<u>No.</u>	<u>IMC NUMBER</u>	<u>CLAIM NAME</u>
1.	415427	Cobre Sud #1
2.	415428	Cobre Sud #2
3.	415429	Cobre Sud #3
4.	415430	Cobre Sud #4
5.	415431	Cobre Sud #5
6.	415432	Cobre Sud #6
7.	415433	Cobre Sud #7
8.	415434	Cobre Sud #8
9.	415435	Cobre Sud #9
10.	415436	Cobre Sud #10
11.	421247	Cobre Sud #11
12.	421248	Cobre Sud #12
13.	421249	Cobre Sud #13
14.	421250	Cobre Sud #14
15.	421251	Cobre Sud #15
16.	421252	Cobre Sud #16

Located in T12N, R2E, Section 30 and T12N, R1E, Section 25, and recorded in the records of Yavapai County, Arizona in Book 4875, pages 577 through 586 and Book 4942, pages 688 through 690 for the benefit of Ivy Minerals Inc.

Submitted by:

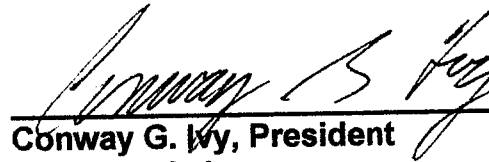

Conway G. Ivy, President  
Ivy Minerals Inc.  
P.O. Box 2532  
Boise, Idaho 83701  
440 - 796 - 7503 [telephone]

PHOENIX, ARIZONA

2014 JUL 24 P 4: 07

RECEIVED  
BLM ARIZONA

United States Department of the Interior  
 Bureau of Land Management  
 LANDS/RECREATION & PLANNING  
 ONE N CENTRAL AVE  
 PHOENIX, AZ 85004 -2203  
 Phone: 602-417-9200

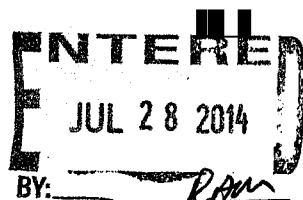

Receipt

No:

3084957

<b>Transaction #:</b> 3176280	
<b>Date of Transaction:</b> 07/25/2014	
<b>CUSTOMER:</b>	
IVY MINERALS INC PO BOX 2532 BOISE, ID 83701-2532 US	

LINE #	QTY	DESCRIPTION	REMARKS	UNIT PRICE	TOTAL
1	1.00	LOCATABLE MINERALS / MINING CLAIMS-NOT NEW-UNADJUD, ONE AUTH NO. ONLY / MINING CLAIM MONEY RECEIVED CASES: AMC415427/\$2480.00	MAINT FEE PYMNT (16) 2015	- n/a -	2480.00
<b>TOTAL:</b>					<b>\$2,480.00</b>

PAYMENT INFORMATION					
1	AMOUNT:	2480.00	POSTMARKED:	07/22/2014	
	TYPE:	CHECK	RECEIVED:	07/24/2014	
	CHECK NO:	2718			
	NAME:	IVY MINERALS INC PO BOX 2532 BOISE ID 83701-2532 US			

REMARKS

This receipt was generated by the automated BLM Collections and Billing System and is a paper representation of a portion of the official electronic record contained therein.

Print postage online - Go to [usps.com/postageonline](http://usps.com/postageonline)

PLEASE PRESS FIRMLY

PLEASE PRESS FIRMLY



1006

85004

U.S. POSTAGE  
PAID  
BEAUFORT, SC  
29902  
JUL 22 '14  
AMOUNT

\$5.60  
00031151-03



# Flat Rate Mailing Envelope

For Domestic and International Use

Visit us at [usps.com](http://usps.com)



Any amount of mailable material may be enclosed, as long as the envelope is not modified, and the contents are entirely confined within the envelope with the adhesive provided as the means of closure.

INTERNATIONAL RESTRICTIONS APPLY:

4-POUND WEIGHT LIMIT ON  
INTERNATIONAL APPLIES

Customs forms are required. Consult the *International Mail Manual (IMM)* at [pe.usps.gov](http://pe.usps.gov) or ask a retail associate for details.

From/Expéditeur:

Conway G. Ivy  
P. O. Box 1408  
Beaufort, SC 29901



USPS TRACKING #



9114 9011 8986 6664 0122 06

LSB400R Aug. 2013  
7690-17-000-0669

To/Destinataire:

United States Bureau of Land Management  
Suite 800  
One North Central Avenue  
Phoenix, Arizona 85004-4427

Country of Destination/Pays de destination:



USPS packaging products have been awarded Cradle to Cradle Certification<sup>SM</sup> for their ecologically-intelligent design. For more information go to [mbdc.com/usps](http://mbdc.com/usps)  
Cradle to Cradle Certified<sup>SM</sup> is a certification mark of MDC.



Recycled Paper



EP14F

This packaging is the property of the U.S. Postal Service<sup>SM</sup> and is provided solely for use in sending Priority Mail<sup>SM</sup> shipments. Misuse may be a violation of federal law. This packaging is not for resale. EP14F © U.S. Postal Service, Oct. 2009; All rights reserved.

082708 PM EFF OCT 2008

RECEIVED  
BLM AZ STATE OFFICE  
2014 JUL 24 P  
PHOENIX, ARIZONA

Please recycle.

AMC 421247  
AMC 415427

Ivy Minerals Inc.  
P. O. Box 2532  
Boise, Idaho 83701

August 3, 2013

VIA FEDERAL EXPRESS

United States Bureau of Land Management  
Suite 800  
One North Central Avenue  
Phoenix, Arizona 85004-4427

Re: Maintenance Fee Payment for Cobre Sud #1 through #16 Claims  
Yavapai County, Arizona

**BLM Serial #'s AMC # 415427 through AMC # 415436 and  
AMC # 421247 through AMC # 421252**

Greetings:

Enclosed is a check in the amount of \$2,240 in payment of the 2013 maintenance fees for the above referenced unpatented lode mining claims. I have enclosed a self-addressed stamped envelope for returning the receipt. Thank you very much for your help in this matter.

Sincerely,

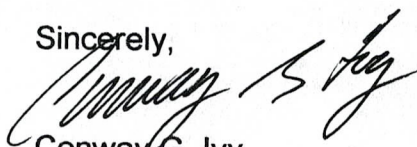

Conway G. Ivy  
President

PHOENIX, ARIZONA

2013 AUG - 6 P 2: 27

RECEIVED  
BLM AZ STATE OFFICE

8/4

NO. OF CLAIMS 16  
AMOUNT \$2240.00  
RECEIPT NO. 2849091  
INIT. CAH

\*\* BLM-ASO\*\*

ENTERED INTO COMPUTER  
AUG 12 2013 TS



**UNITED STATES BUREAU OF LAND MANAGEMENT  
CLAIM MAINTENANCE FEES  
August 3, 2013**

Enclosed are claim maintenance fees in the amount of \$2,240.00 [\$140.00 per claim] for the Claims listed below:

<u>No.</u>	<u>IMC NUMBER</u>	<u>CLAIM NAME</u>
1.	415427	Cobre Sud #1
2.	415428	Cobre Sud #2
3.	415429	Cobre Sud #3
4.	415430	Cobre Sud #4
5.	415431	Cobre Sud #5
6.	415432	Cobre Sud #6
7.	415433	Cobre Sud #7
8.	415434	Cobre Sud #8
9.	415435	Cobre Sud #9
10.	415436	Cobre Sud #10
11.	421247	Cobre Sud #11
12.	421248	Cobre Sud #12
13.	421249	Cobre Sud #13
14.	421250	Cobre Sud #14
15.	421251	Cobre Sud #15
16.	421252	Cobre Sud #16

Located in T12N, R2E, Section 30 and T12N, R1E, Section 25, and recorded in the records of Yavapai County, Arizona in Book 4875, pages 577 through 586 and Book 4942, pages 688 through 690 for the benefit of Ivy Minerals Inc.

Submitted by:

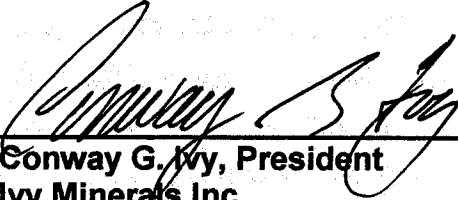
  
\_\_\_\_\_  
Conway G. Ivy, President  
Ivy Minerals Inc.  
P.O. Box 2532  
Boise, Idaho 83701  
440 - 796 - 7503 [telephone]

RECEIVED  
BLM AZ STATE OFFICE  
AUG - 6 P 2: 27  
TUCSON, ARIZONA

**United States Department of the Interior**  
**Bureau of Land Management**  
 LANDS/RECREATION & PLANNING  
 ONE N CENTRAL AVE  
 PHOENIX, AZ 85004 -2203  
 Phone: 602-417-9200

Receipt

No: 2849091

<b>Transaction #:</b> 2934801	
<b>Date of Transaction:</b> 08/07/2013	
CUSTOMER:	
IVY MINERALS INC PO BOX 2532 BOISE, ID 83701-2532 US	

LINE #	QTY	DESCRIPTION	REMARKS	UNIT PRICE	TOTAL
1	1.00	LOCATABLE MINERALS / MINING CLAIMS-NOT NEW-UNADJUD, ONE AUTH NO. ONLY / MINING CLAIM MONEY RECEIVED CASES: AMC415427/\$2240.00	MAINT FEE PYMNT (16) 2014	- n/a -	2240.00
<b>TOTAL:</b>					<b>\$2,240.00</b>

PAYMENT INFORMATION					
1	AMOUNT:	2240.00	POSTMARKED:	08/06/2013	
	TYPE:	CHECK	RECEIVED:	08/06/2013	
	CHECK NO:	2517			
	NAME:	IVY MINERALS INC PO BOX 2532 BOISE ID 83701-2532 US			

REMARKS

This receipt was generated by the automated BLM Collections and Billing System and is a paper representation of a portion of the official electronic record contained therein.

**NOTICE!!**

**These documents have been scanned!**

**Do not place un-scanned documents beneath this notice!**

**Do not remove this notice from this file!**

GPO Jacket No. 560-102  
Print Order 61540  
Rise Business Services, LLC  
Job=AZ15 5/13/2019



Box Number= AZ15041



Claim Begin-End: AMC421247-AMC421252

6 Location Notices-Amendments and Supporting Documents



AZ15041-15

AMC421078-AMC422564

# MINING CLAIM STATUS REPORT

DATA ENTERED MAR 05 2013<sup>PS</sup>  
2/25/13

MTP Checked by NCH  
GEO Checked by NCH MAR 05 2013<sup>PS</sup>

LEAD SERIAL NUMBER AMC 421247 thru AMC 421252

# OF CLAIMS & TYPE	CHARGES
# <u>0</u> LODE	Location Fee @ \$34 = \$ <u>204</u>
# _____ PLACER	Processing Fee @ \$15 = \$ <u>90</u>
# _____ ASSOCIATION PLACER	Maintenance Fee @ \$140 = \$ <u>840</u>
# _____ MILL SITE	Overage (+) \$ _____
# _____ TUNNEL SITE	Shortage (-) \$ _____
	Other Fees \$ _____
	<b>TOTAL \$ <u>1134</u></b>

TOTAL CLAIM ACREAGE? \_\_\_\_\_

# OF LOCATORS? \_\_\_\_\_

DOCUMENTS RECEIVED VIA -  
Over-the-Counter  Mail

TIMELY FILED?  
Yes  No

LEGAL DESCRIPTION - T 12N R 2E SEC 30  
 T 12N R 1E SEC 25  
 T \_\_\_\_\_ R \_\_\_\_\_ SEC \_\_\_\_\_  
 T \_\_\_\_\_ R \_\_\_\_\_ SEC \_\_\_\_\_

BLM  FOREST SERVICE  SUBJ TO PL 359: Yes  No

WILDERNESS AREA: No  Yes

SPLIT ESTATE - N/A  SX  PX  SRHA  OTHER

Proper Notice Filed if Located on SHRA Lands? N/A  Yes  No

RECONVEYED MINERALS ON BLM LANDS REQUIRE OPENING ORDERS FROM 1944 TO 1993 -

Open to Entry on: \_\_\_\_\_ N/A

COMMENTS/STATUS - VOID  PARTIALLY VOID  PVT MINERALS  WITHDRAWN LANDS   
OTHER

Claimant acknowledges that portions of the following claims(s) site(s) may be void or voidable.

Printed Name of Claimant \_\_\_\_\_ Signature of Claimant \_\_\_\_\_

\*\*\*\*\* FINAL ADJUDICATION \*\*\*\*\*

469 ✓

DATE 4/14/2013 INITIALS TS

AMC 421247

BLM  
Date  
Stamp

LOCATION NOTICE FOR LODE MINING CLAIM

NOTICE IS HEREBY GIVEN that Cobre Sud 11 lode mining claim has been located by Ivy Minerals, Inc. whose current mailing address is P.O. Box 2532, Boise, Idaho 83701

The general course of this claim is North-South and it is situated in Yavapai County, Arizona. This claim is 1500 feet in length and 600 feet in width. This claim runs from the location monument on which this location notice is posted approximately 1480 feet in a southerly direction to the south end line and 10 feet in a northerly direction to the north end line. This claim is marked by six monuments, one at each corner and one at the center of each end line of the claim.

The location monument on which this notice is posted is situated within Section 36, Township 12N, Range 2E, Gila Salt River Base and Meridian, Arizona and this claim encompasses portions of the following quarter section (s), section (s), Township (s) and Range (s) SW 1/4 Sec 30, T12N, R2E  
Gila Salt River Base and Meridian, Arizona.

The locality of this claim with reference to some natural object or permanent monument and additional information (if any) concerning its locality are as follows: The NE corner is 600' N and 2900' west of USLM 1746

DATED AND POSTED on the ground this 17<sup>th</sup> day of December, 2012.

LOCATOR (s) Paul F. O'Keefe  
Agent for Ivy Minerals, Inc.

Form MCF100  
Revised July 2005

This form is available from the Arizona Department of Mines & Mineral Resources and may be reproduced.

PHOENIX, AZ

2013 FEB 25 A 10: 01

RECEIVED  
B.L.M. AZ STATE OFFICE

AMC 1121247

**MINING CLAIM MAP**

Lode (X) Placer ( )

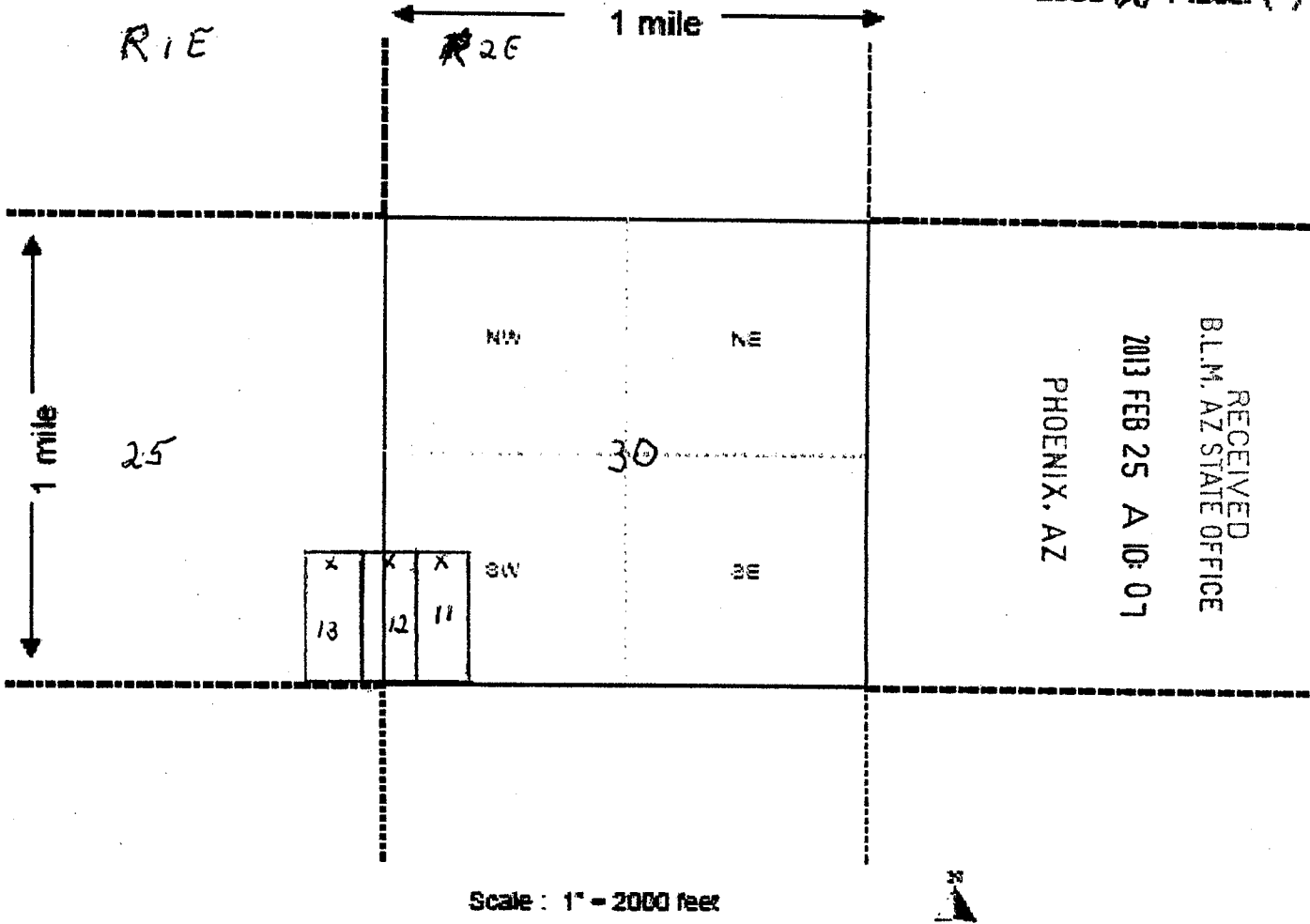

AMC121247

1. The above map depicts the Cobre Sud 11 mining claim, which is located in Section (s) 30, Township 12N, Range 2E, Gila and Salt River Base and Meridian, Yavapai County, Arizona.

2. The type of corner and location monuments used are as follows: 2" x 2" posts, 5' length

3. The bearings and distances in degrees and feet between claim corners are as depicted on the map.

BLM  
Date  
Stamp

LOCATION NOTICE FOR LODE MINING CLAIM

NOTICE IS HEREBY GIVEN that Cobre Sud 12 lode mining claim has been located by Ivy Minerals, Inc. whose current mailing address is P.O. Box 2532, Boise, Idaho 83701

The general course of this claim is North-South and it is situated in Yavapai County, Arizona.

This claim is 1500 feet in length and 600 feet in width. This claim runs from the location monument on which this location notice is posted approximately 1490 feet in a southerly direction to the south end line and 10 feet in a northerly direction to the north end line. This claim is marked by six monuments, one at each corner and one at the center of each end line of the claim.

The location monument on which this notice is posted is situated within Section 30 25, Township 12N, Range 2E 1E, Gila Salt River Base and Meridian, Arizona and this claim encompasses portions of the following quarter section (s), section (s), Township (s) and Range (s) SW 1/4 sect 30, T12N R2E and SE 1/4 sect 25, T12N R1E Gila Salt River Base and Meridian, Arizona.

The locality of this claim with reference to some natural object or permanent monument and additional information (if any) concerning its locality are as follows: The NE corner is 600' N and 3500' west of USLM 1746

DATED AND POSTED on the ground this 17<sup>th</sup> day of December, 20 12.  
LOCATOR (s) Patrick F. O'Hara

Agent for Ivy Minerals, Inc.

Form MCF100  
Revised July 2005

This form is available from the Arizona Department of Mines & Mineral Resources and may be reproduced.

RECEIVED  
B.L.M. AZ STATE OFFICE  
2013 FEB 25 A 10: 01  
PHOENIX, AZ

AM0491248

**MINING CLAIM MAP**

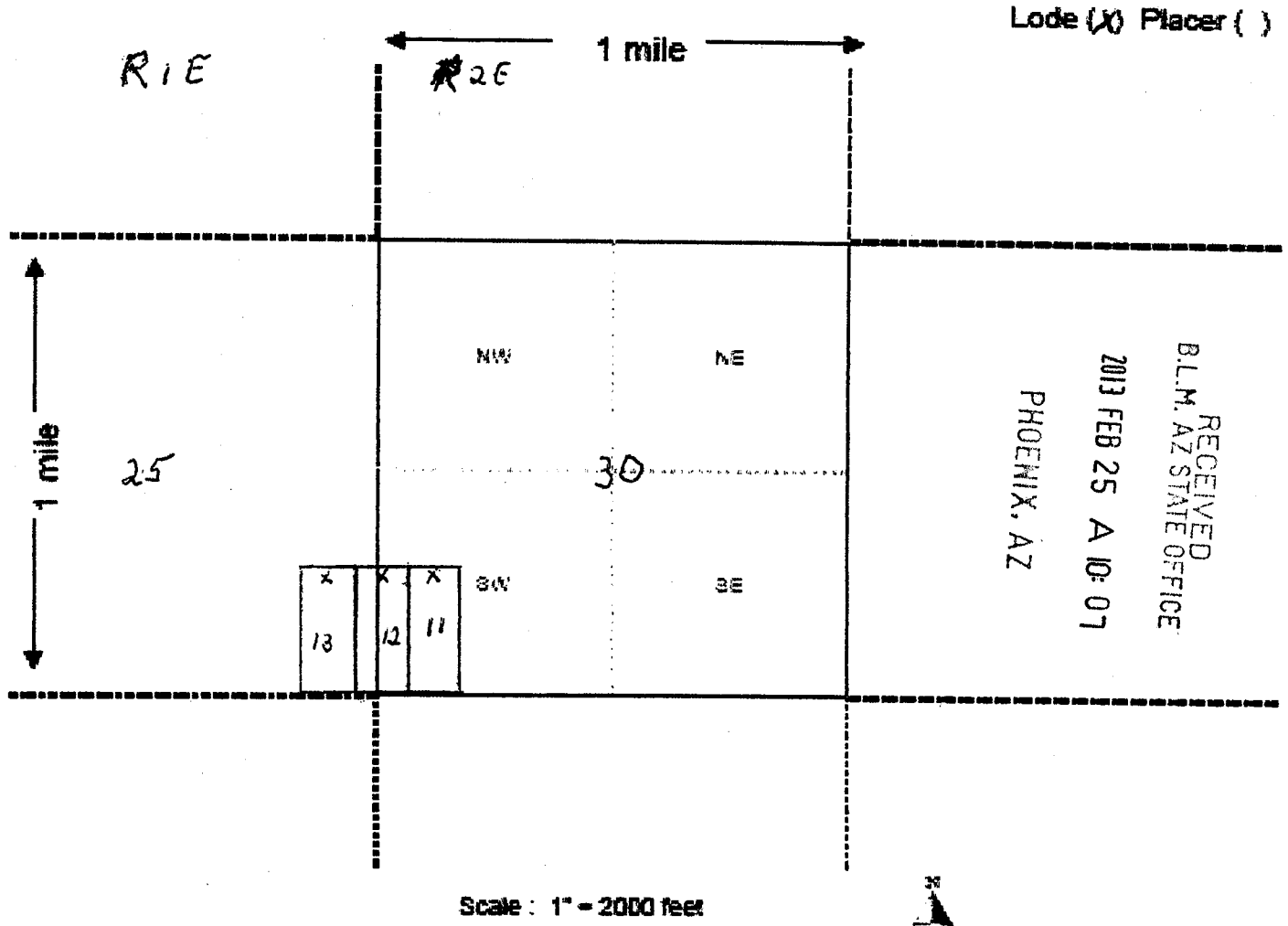

1. The above map depicts the Cobre Sud 12 mining claim, which is located in Section (s) 30 25, Township 12N, Range 2E 1E, Gila and Salt River Base and Meridian, Yavapai County, Arizona.

2. The type of corner and location monuments used are as follows: 2" x 2" posts, 5' length

3. The bearings and distances in degrees and feet between claim corners are as depicted on the map.

Form MCF100a  
Revised July 2005

This form is available from the Arizona Department of Mines & Mineral Resources and may be reproduced.



BLM  
Date  
Stamp

LOCATION NOTICE FOR LODE MINING CLAIM

NOTICE IS HEREBY GIVEN that Cobre Sud 13 lode mining claim has been located by Ivy Minerals, Inc. whose current mailing address is P.O. Box 2532, Boise, Idaho 83701

The general course of this claim is North-South and it is situated in Yavapai County, Arizona.

This claim is 1500 feet in length and 600 feet in width. This claim runs from the location monument on which this location notice is posted approximately 1480 feet in a southerly direction to the south end line and 10 feet in a northerly direction to the north end line. This claim is marked by six monuments, one at each corner and one at the center of each end line of the claim.

The location monument on which this notice is posted is situated within Section 25, Township 12N, Range 1E, Gila Salt River Base and Meridian, Arizona and this claim encompasses portions of the following quarter section (s), section (s), Township (s) and Range (s) SE 1/4 sect 25 T12N R1E  
Gila Salt River Base and Meridian, Arizona.

The locality of this claim with reference to some natural object or permanent monument and additional information (if any) concerning its locality are as follows: The NE corner is 600' N and 400' west of USLM 1746

DATED AND POSTED on the ground this 17<sup>th</sup> day of December, 2012.

LOCATOR (s) Patrick F. O'Hara  
Agent for Ivy Minerals, Inc.

Form MCF100  
Revised July 2005

This form is available from the Arizona Department of Mines & Mineral Resources and may be reproduced.

RECEIVED  
BLM, AZ STATE OFFICE  
2013 FEB 25 A 10: 01  
PHOENIX, AZ

AMC421249

**MINING CLAIM MAP**

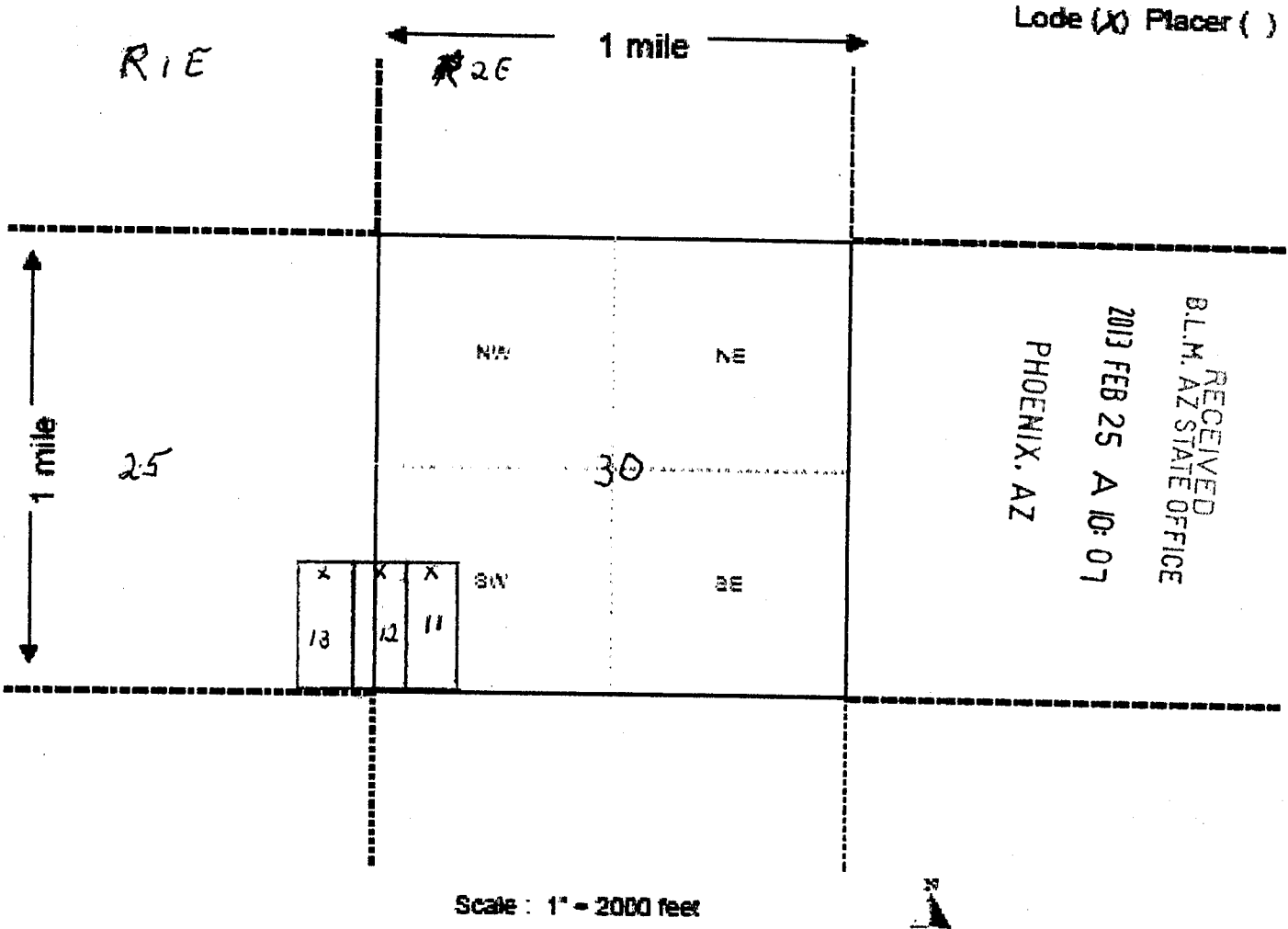

AH0421249

1. The above map depicts the Cobre Sud 13 mining claim, which is located in Section (s) 25, Township 12N, Range 1E, Gila and Salt River Base and Meridian, Yavapai County, Arizona.

2. The type of corner and location monuments used are as follows: 2" x 2" posts, 5' length

3. The bearings and distances in degrees and feet between claim corners are as depicted on the map.

BLM  
Date  
Stamp

LOCATION NOTICE FOR LODE MINING CLAIM

NOTICE IS HEREBY GIVEN that Cobre Sud 14 lode mining claim has been located by Ivy Minerals, Inc whose current mailing address is P.O. Box 2532, Boise Idaho 83701

The general course of this claim is north-south and it is situated in Yavapai County, Arizona.

This claim is 1500 feet in length and 600 feet in width. This claim runs from the location monument on which this location notice is posted approximately 1490 feet in a northerly direction to the north end line and 10 feet in a southerly direction to the south end line. This claim is marked by six monuments, one at each corner and one at the center of each end line of the claim.

The location monument on which this notice is posted is situated within Section 30, Township 12N, Range 2E, Gila Salt River Base and Meridian, Arizona and this claim encompasses portions of the following quarter section (s), section (s), Township (s) and Range (s) SW 1/4 and NW 1/4 sect 30, T12N, R2E Gila Salt River Base and Meridian, Arizona.

The locality of this claim with reference to some natural object or permanent monument and additional information (if any) concerning its locality are as follows: The SE corner is 600' N and 2900' west of US 201 1746

DATED AND POSTED on the ground this 22 day of February, 2013.  
LOCATOR (s) Patrick F. O'Hare  
agent for Ivy Minerals, Inc

Form MCF100  
Revised July 2005

This form is available from the Arizona Department of Mines & Mineral Resources and may be reproduced.

PHOENIX, AZ

2013 FEB 25 A 10:07

RECEIVED  
B.L.M. AZ STATE OFFICE

AMC421250

**MINING CLAIM MAP**

Lode (x) Placer ( )

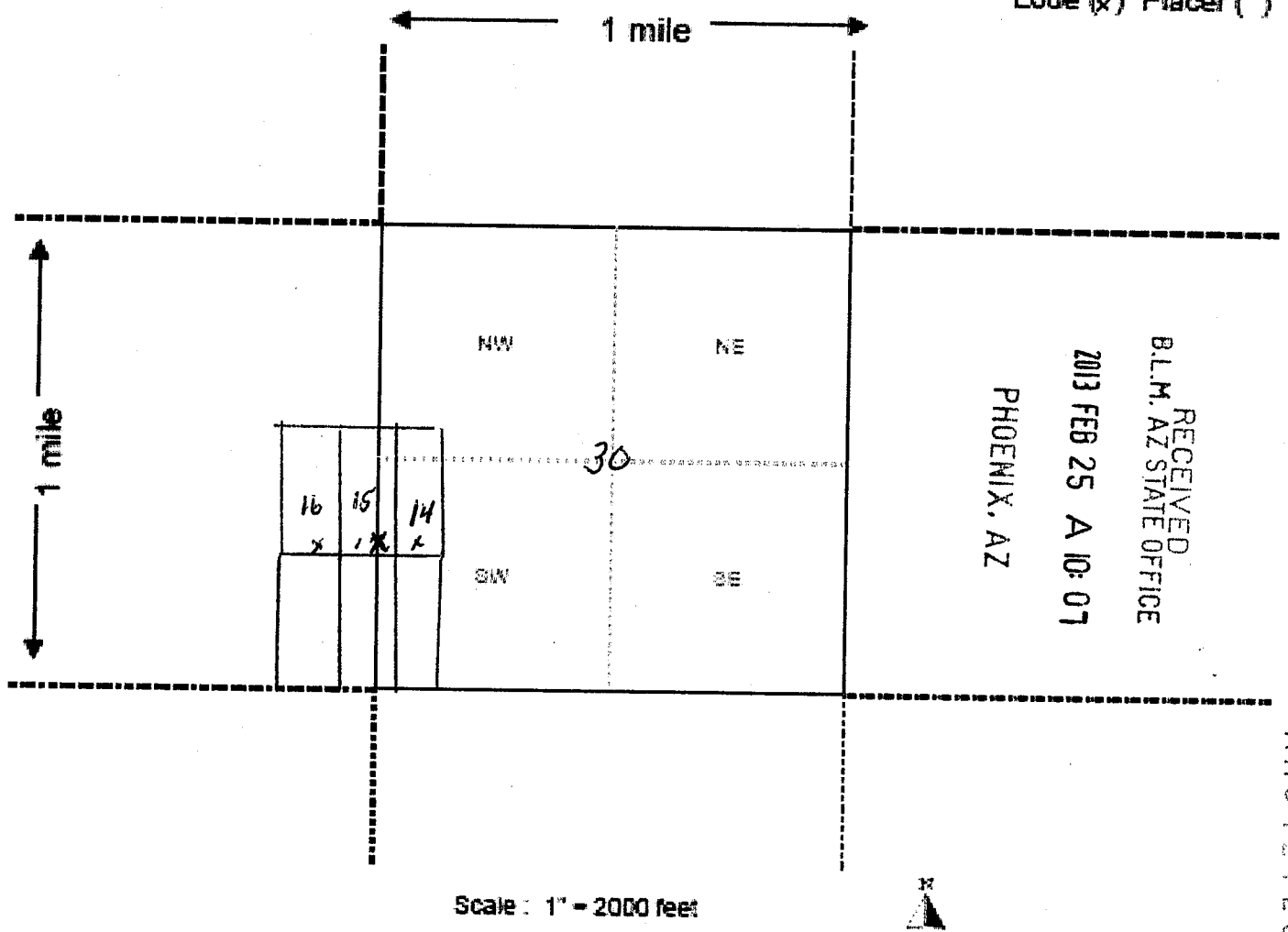

ANCH 21250

1. The above map depicts the Cobre Sud 14 mining claim, which is located in Section (s) 30, Township 12 N, Range 2E, Gila and Salt River Base and Meridian, Yavapai County, Arizona.

2. The type of corner and location monuments used are as follows: 2x2" posts 5' length

3. The bearings and distances in degrees and feet between claim corners are as depicted on the map.

**Form MCF100a**  
Revised July 2005

This form is available from the **Arizona Department of Mines & Mineral Resources** and may be reproduced.

BLM  
Date  
Stamp

LOCATION NOTICE FOR LODE MINING CLAIM

NOTICE IS HEREBY GIVEN that Cobre Sud 15 lode mining claim has been located by Ivy Minerals, Inc whose current mailing address is P.O. Box 2532, Boise, Idaho 83701

The general course of this claim is north-south and it is situated in Yavapai County, Arizona.

This claim is 1500' feet in length and 600 feet in width. This claim runs from the location monument on which this location notice is posted approximately 1490 feet in a northerly direction to the north end line and 10 feet in a southerly direction to the south end line. This claim is marked by six monuments, one at each corner and one at the center of each end line of the claim.

The location monument on which this notice is posted is situated within Section 30 25, Township T12N, Range 2E 1E, Gila Salt River Base and Meridian, Arizona and this claim encompasses portions of the following quarter section (s), section (s), Township (s) and Range (s) SW 1/4 and NW 1/4 sect of T12N, R2E and SE 1/4 and NE 1/4 sect of T12N, R1E Gila Salt River Base and Meridian, Arizona.

The locality of this claim with reference to some natural object or permanent monument and additional information(if any) concerning its locality are as follows: The SE corner is 600' N and 3500' west of USLM 1746

DATED AND POSTED on the ground this 22 day of February, 2013.  
LOCATOR (s) Patrick F. O'Hara  
Agent For Ivy Minerals, Inc.

Form MCF100  
Revised July 2005

This form is available from the **Arizona Department of Mines & Mineral Resources** and may be reproduced.

PHOENIX, AZ

2013 FEB 25 A 10:07

RECEIVED  
BLM, AZ STATE OFFICE

A110421251

**MINING CLAIM MAP**

Lode (x) Placer ( )

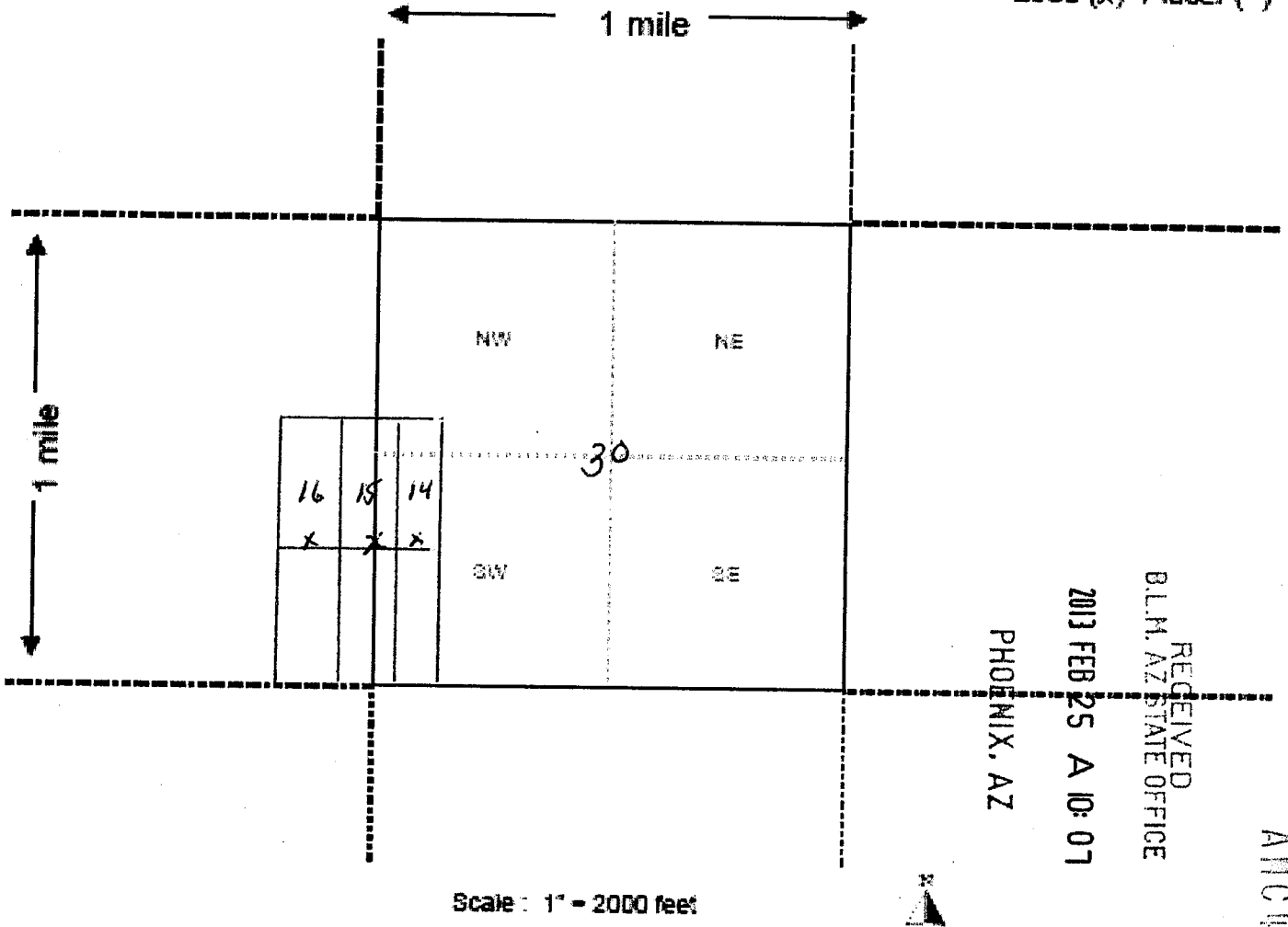

1. The above map depicts the Cobac Sud 15 mining claim, which is located in Section (s) 30 25, Township 12N, Range 2E 1E, Gila and Salt River Base and Meridian, Yavapai County, Arizona.

2. The type of corner and location monuments used are as follows: 2" x 2" wood posts, 5' length

3. The bearings and distances in degrees and feet between claim corners are as depicted on the map.

**Form MCF100a**

Revised July 2005

This form is available from the **Arizona Department of Mines & Mineral Resources** and may be reproduced.

BLM  
Date  
Stamp

LOCATION NOTICE FOR LODE MINING CLAIM

NOTICE IS HEREBY GIVEN that Cobre Sud 16 lode mining claim has been located by Ivy Minerals, Inc whose current mailing address is P.O. Box 2532, Boise, Idaho 83701

The general course of this claim is North-South and it is situated in Yavapai County, Arizona.

This claim is 1500 feet in length and 600 feet in width. This claim runs from the location monument on which this location notice is posted approximately 1450 feet in a northerly direction to the North end line and 10 feet in a southerly direction to the South end line. This claim is marked by six monuments, one at each corner and one at the center of each end line of the claim.

The location monument on which this notice is posted is situated within Section 25, Township 12N, Range 1E, Gila Salt River Base and Meridian, Arizona and this claim encompasses portions of the following quarter section (s), section (s), Township (s) and Range (s) SE 1/4 and NE 1/4 Sect 25 T12N, R1E Gila Salt River Base and Meridian, Arizona.

The locality of this claim with reference to some natural object or permanent monument and additional information (if any) concerning its locality are as follows: The SE cor is 600' North and 4100 feet west of USLM 1746

DATED AND POSTED on the ground this 22 day of February, 2013.

LOCATOR (s) Patrick F. Otter  
Agent for Ivy Minerals, Inc.

Form MCF100  
Revised July 2005

This form is available from the Arizona Department of Mines & Mineral Resources and may be reproduced.

PHOENIX, AZ

2013 FEB 25 A 10: 07

RECEIVED  
B.L.M. AZ STATE OFFICE

AH0421252

**MINING CLAIM MAP**

Lode (x) Placer ( )

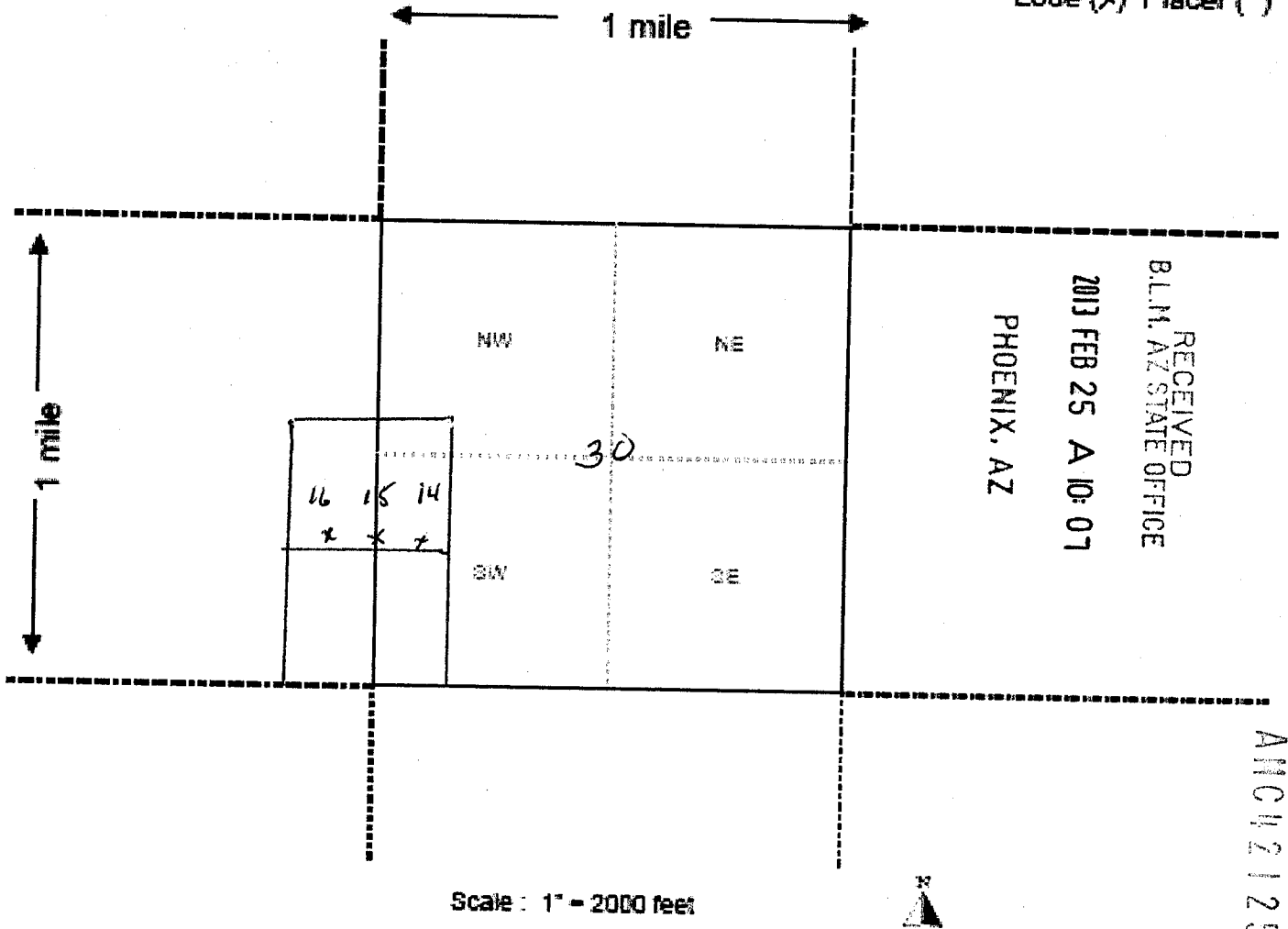

1. The above map depicts the Cobre Sud 16 mining claim, which is located in Section (s) 25, Township 12 N, Range 15, Gila and Salt River Base and Meridian, Yavapai County, Arizona.
2. The type of corner and location monuments used are as follows: 2" x 2" wood posts, 15' length
3. The bearings and distances in degrees and feet between claim corners are as depicted on the map.



RUN TIME: 02:16 PM

Adm State: AZ

UNITED STATES DEPARTMENT OF INTERIOR  
BUREAU OF LAND MANAGEMENT  
GEOGRAPHIC REPORT WITH LAND  
Sorted by Meridian Township Range

RUN DATE: 03/05/2013  
Page 1 of 1

Serial Number: AZA 002936  
Total Case Acres: 65,501.000

<u>Casetype</u>	<u>Case Disp</u>	14	0120N	0020E	<u>Sect</u>	<u>Sur Typ</u>	<u>Sur Num</u>	<u>Suff</u>	<u>Subdivision</u>	<u>Act Pend</u>
246100	AUTHORIZED				030	ALIQ LOTS			NE,E2NW; 1,2;	

Serial Number: AZA 032530  
Total Case Acres: 9.090

<u>Casetype</u>	<u>Case Disp</u>	14	0120N	0020E	<u>Sect</u>	<u>Sur Typ</u>	<u>Sur Num</u>	<u>Suff</u>	<u>Subdivision</u>	<u>Act Pend</u>
281001	AUTHORIZED				030	ALIQ FF			NENW; PORTION OF MS 4626;	

Serial Number: AZA 032561  
Total Case Acres: 9.090

<u>Casetype</u>	<u>Case Disp</u>	14	0120N	0020E	<u>Sect</u>	<u>Sur Typ</u>	<u>Sur Num</u>	<u>Suff</u>	<u>Subdivision</u>	<u>Act Pend</u>
281001	AUTHORIZED				030	ALIQ FF			NENW; PORTION OF MS 4626;	

Input Parameters for Geographic Report with Land

System Id = CR

Admin State = AZ

Geo State = AZ

Casetype Begins With

Case Disp Txt = AUTHORIZED, CANCELLED, EXPIRED, PENDING, REJECTED, RELINQUISHED, WITHDRAWN

Mer Twp Rng =

Section =

Mtrs = 14 0120N 0010E 025, 14 0120N 0010E 999, 14 0120N 0020E 030, 14 0120N 0020E 999

Commodity =

Commodity Txt =

Pending Org =

Pend Org Decode =

Total Rows Returned: 6

# TOWNSHIP 12 NORTH RANGE 1 EAST OF THE GILA AND SALT RIVER MERIDIAN, ARIZONA

YAVAPAI COUNTY

STATUS OF PUBLIC DOMAIN  
LAND AND MINERAL TITLES

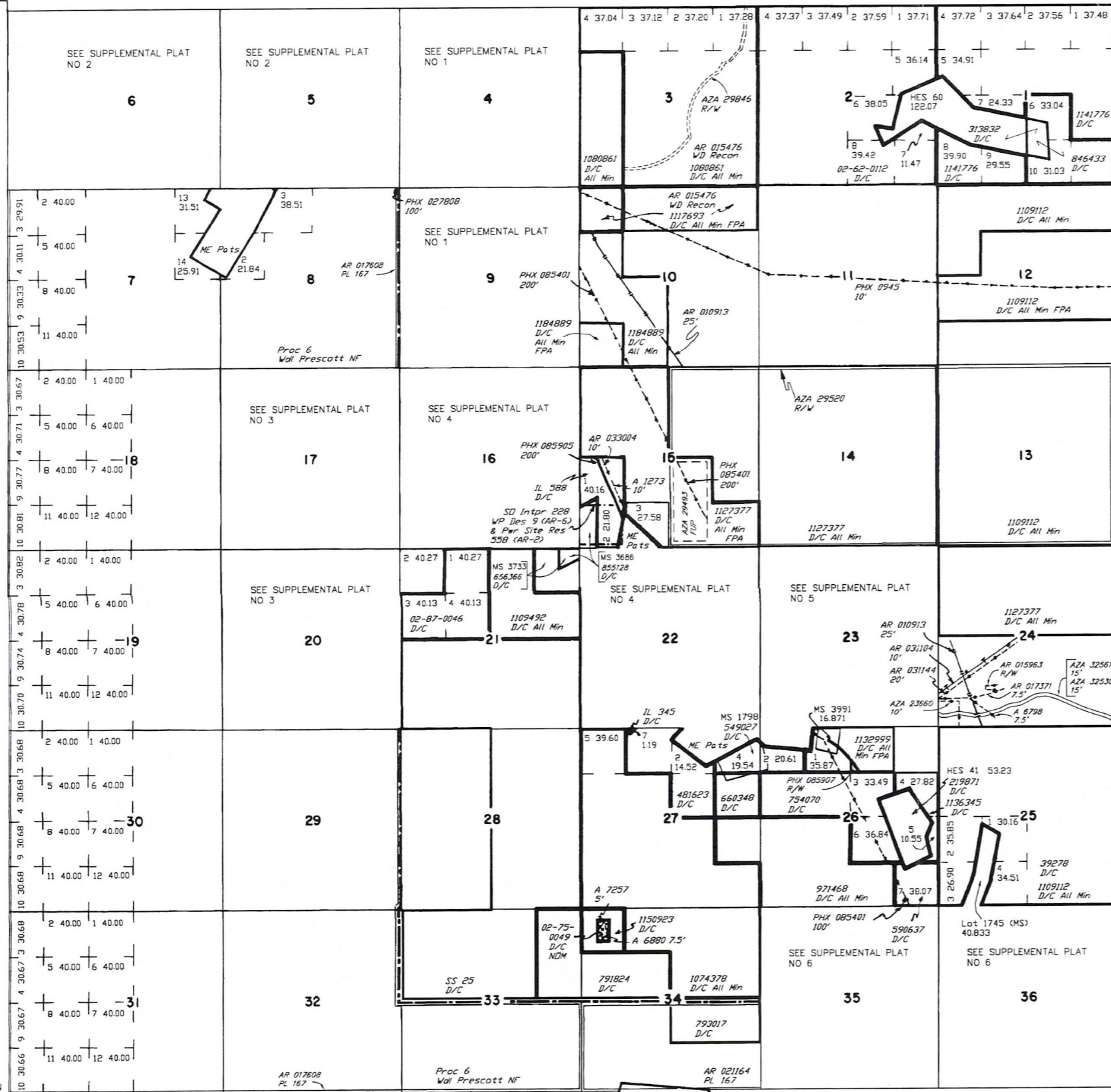

INDEX TO SEGREGATED TRACTS				
RESURVEY TRACT NO	ORIGINAL SURVEY			
	T	R	SEC	SUBDIVISION

FOR ORDERS AFFECTING DISPOSAL OR USE OF UNIDENTIFIED LANDS WITHDRAWN FOR CLASSIFICATION, MINERALS, WATER AND/OR OTHER PUBLIC PURPOSES, REFER TO INDEX OF MISCELLANEOUS DOCUMENTS.

DIST NO 2

LANDS PATENTED UNDER SMALL TRACT ACT ARE NOM - SUBJECT TO MINERAL LEASING ACT

MDS 13 NE  
14 NW  
15 SE

A 7631 PL 359  
Secs 3,4

A 8644 PL 359  
Secs 4,9

AZA 25635 USE Per 3.97A  
Sec 24 : W1/2SW1/4 M&B

Lat 34°22'24"N  
Long 112°18'27"W

Lat 34°22'24"N  
Long 112°12'06"W

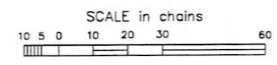

**WARNING STATEMENT**  
This plat is the Bureau's Record of Title, and should be used only as a graphic display of the township survey data. Records herein do not reflect title changes which may have been effected by lateral movements of rivers or other bodies of water. Refer to the cadastral surveys for official survey information.

CURRENT TO	GS	T	R
5-3-2004	PV	12 N	1 E

# TOWNSHIP 12 NORTH RANGE 2 EAST OF THE GILA AND SALT RIVER MERIDIAN, ARIZONA

YAVAPAI COUNTY  
HASSAYAMPA FIELD OFFICE

STATUS OF PUBLIC DOMAIN  
LAND AND MINERAL TITLES

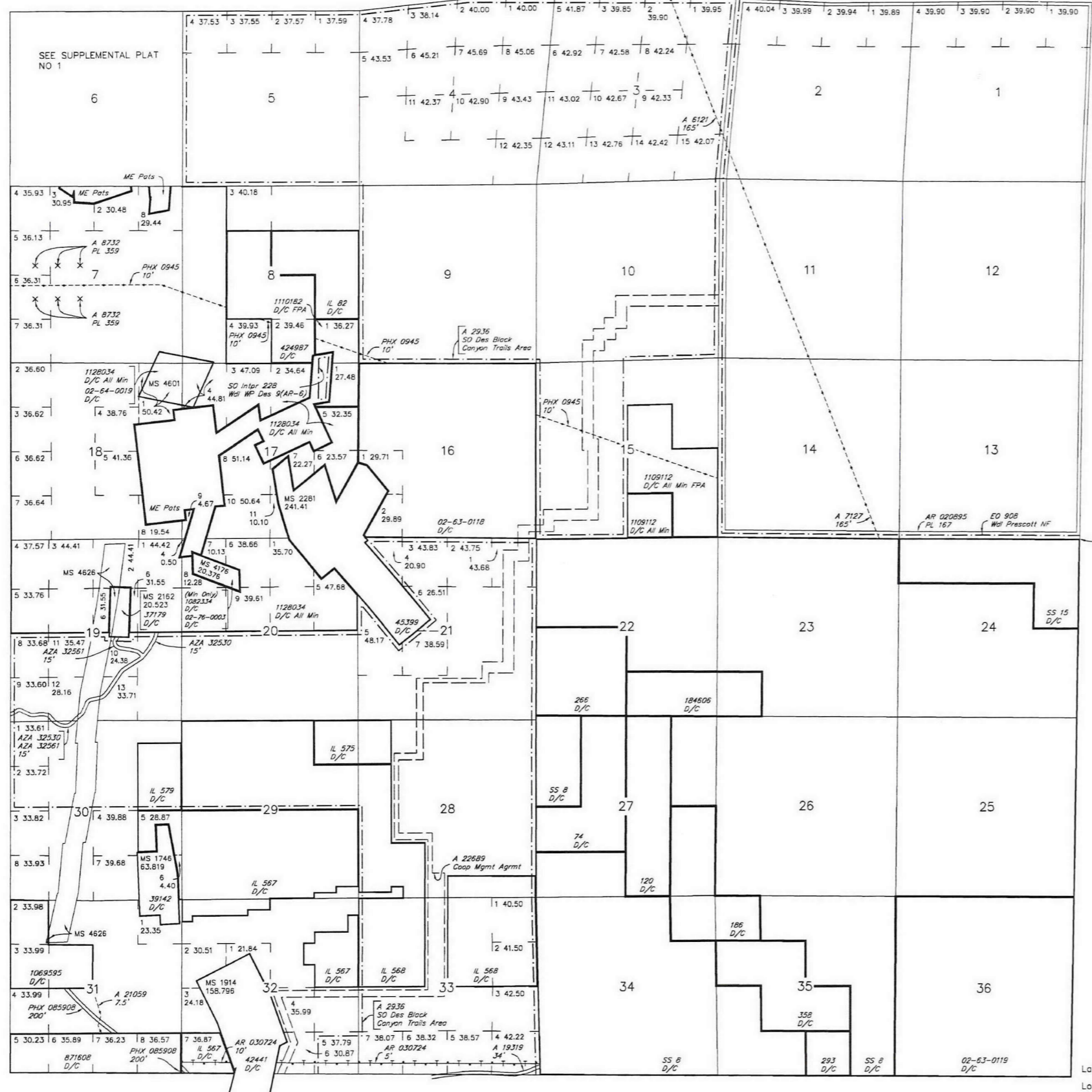

INDEX TO SEGREGATED TRACTS				
RESURVEY	ORIGINAL SURVEY			
	TRACT NO	T	R	SEC

*FOR ORDERS AFFECTING DISPOSAL OR USE OF UNIDENTIFIED LANDS WITHDRAWN FOR CLASSIFICATION, MINERALS, WATER AND/OR OTHER PUBLIC PURPOSES, REFER TO INDEX OF MISCELLANEOUS DOCUMENTS.*

- MDS 45 NW
- 46 SW
- PHX 085902 R/W
- Sec 32 : SW1/4SW1/4

Lot 34°24'50"N  
Long 112°05'36"W

Lot 34°22'08"N  
Long 112°05'23"W

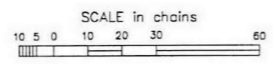

**WARNING STATEMENT**  
This plot is the Bureau's Record of Title, and should be used only as a graphic display of the township survey data. Records herein do not reflect title changes which may have been effected by lateral movements of rivers or other bodies of water. Refer to the cadastral surveys for official survey information.

CURRENT TO	BT	GSR Mer
8-25-2008	ACAD	T 12 N
		R 2 E